



DEPARTMENT OF THE ARMY
JACKSONVILLE DISTRICT CORPS OF ENGINEERS
9900 SOUTHWEST 107th Ave, SUITE 203
MIAMI, FLORIDA 33176

REPLY TO
ATTENTION OF

Regulatory Division
South Permits Branch
South Permits Section

February 21, 2020

PUBLIC NOTICE

Permit Application Number SAJ-2017-01843 (SP-AG)

TO WHOM IT MAY CONCERN: The Jacksonville District of the U.S. Army Corps of Engineers (Corps) has received an application for a Department of the Army permit pursuant to Section 404 of the Clean Water Act (33 U.S.C. §1344) and Section 10 of the Rivers and Harbors Act of 1899 (33 U.S.C. §403) as described below:

APPLICANT: 5th Street Marina, LLC
c/o Orin Black
341 NW South River Drive
Miami, FL 33128

WATERWAY AND LOCATION: The project would affect waters of the United States associated with the Miami River. The project site is located at 405 & 431 NW S. River Drive and also 801 NW 4th Street, in Section 38, Township 54 South, Range 41 East, Miami, Miami-Dade County, Florida (Folio # 01-0200-1010, -1020, 01-4138-003-0130).

Directions to the site are as follows: From the Dolphin Expressway (SR836), take exit NW 12th Avenue. Head South until NW 7th Street and make a left. Continue East on NW 7th Street until you merge onto NW South River Drive. Continue South on NW South River Drive and the property is located on the left hand side at the corner of NW 8th Street and NW South River Drive.

APPROXIMATE CENTRAL COORDINATES:

Latitude 25.778803°
Longitude -80.208389°

PROJECT PURPOSE:

Basic: The basic project purpose is for shoreline stabilization and dredging to improve water ingress and egress for an existing boatyard.

Overall: The overall project purpose is to conduct shoreline modifications and dredging and install a new travel lift at a property located on the Miami River, Miami-Dade County, Florida.

EXISTING CONDITIONS: The project is located on the Miami River at an existing commercial facility. The existing river bottom adjacent to the existing shoreline is not anticipated to contain any benthic resources. No corals or submerged aquatic vegetation is anticipated to be impacted by the proposed project. Juvenile fish species, sponges, filamentous algae and other invertebrates and sponges are likely to be the only resources using this area.

PROPOSED WORK: The applicant seeks authorization to conduct 2,210 square feet of maintenance dredging; conduct 2,210 square feet of non-maintenance dredging (down to -9.0 MLW); creation of a new travel lift basin for a new 110-ton motorized travel lift; install 22'-8" of new steel sheet pile and associated concrete seawall cap to support the travel lift; install 327'-11" of new steel sheet pile seawall with an associated 3' x 2' concrete seawall cap and 74- 14" x 14" concrete piles to close in the existing basin and fill it with 24,491.7 square feet (7,256 cubic yards) of clean fill.

AVOIDANCE AND MINIMIZATION INFORMATION: The applicant has provided the following information in support of efforts to avoid and/or minimize impacts to the aquatic environment:

The proposed project footprint does not contain any submerged aquatic vegetation therefore the project will not create any adverse impacts to benthic resources. The applicant is proposing to minimize temporary turbidity impacts by deploying turbidity curtains during the construction phase.

COMPENSATORY MITIGATION: If it is determined that the issuance of a DA permit is appropriate, mitigation may be required. Evaluation of the final mitigation proposal will be based on the Wetland Assessment Technique for Environmental Review (WATER) for the Florida Power & Light (FPL) Everglades Mitigation Bank (EMB) or Uniform Mitigation Assessment Method (UMAM). Time lag and risk will be a required component of any mitigation requirement.

CULTURAL RESOURCES: The Corps has determined the permit area has been extensively modified by previous work and there is little likelihood a historic property may be affected therefore, the proposed project would have "No Potential to Cause Effect".

ENDANGERED SPECIES: The U.S. Army Corps of Engineers (Corps) has determined the project "may affect, but is not likely to adversely affect" the West Indian manatee (*Trichechus manatus*) or its designated critical habitat. Since the proposal by the applicant is for in-water construction, potential impacts to the endangered manatee were evaluated using The Corps of Engineers, Jacksonville District, and the State of Florida Effect Determination Key for the Manatee in Florida (Manatee Key), dated 25 April 2013. Use of the Manatee Key resulted in the following sequential determination:

A > B > C > D > E > F > G > N > O > P > "MANLAA." The Corps will request the U.S. Fish and Wildlife Service consultation with these determinations pursuant to Section 7 of the Endangered Species Act by separate letter.

The Corps has determined that the project will have no effect on any other listed threatened or endangered species, and/or designated critical habitat.

ESSENTIAL FISH HABITAT (EFH): This notice initiates consultation with the National Marine Fisheries Service on EFH as required by the Magnuson-Stevens Fishery Conservation and Management Act 1996. The proposal would impact approximately 10,995 square feet of un-vegetated river bottom utilized by various life stages of juvenile fish and invertebrates commonly observed in Miami- Dade County. Our initial determination is that the proposed action would not have a substantial adverse impact on EFH or Federally managed fisheries in the Miami River and Biscayne Bay. Our final determination relative to project impacts and the need for mitigation measures is subject to review by and coordination with the National Marine Fisheries Service.

NOTE: This public notice is being issued based on information furnished by the applicant. This information has not been verified or evaluated to ensure compliance with laws and regulation governing the regulatory program. The jurisdictional line has not been verified by Corps personnel.

AUTHORIZATION FROM OTHER AGENCIES: Water Quality Certification may be required from the Florida Department of Environmental Protection and/or one of the state Water Management Districts.

COMMENTS regarding the potential authorization of the work proposed should be submitted in writing to the attention of the District Engineer through the Miami Permits Section, 9900 SW 107th Avenue, Suite #203, Miami, Florida 33176 within 21 days from the date of this notice.

The decision whether to issue or deny this permit application will be based on the information received from this public notice and the evaluation of the probable impact to the associated wetlands. This is based on an analysis of the applicant's avoidance and minimization efforts for the project, as well as the compensatory mitigation proposed.

QUESTIONS concerning this application should be directed to the project manager, Albert Gonzalez, in writing at the Miami Permits Section, 9900 SW 107th Avenue, Suite #203, Miami, Florida 33176, by electronic mail at albert.gonzalez@usace.army.mil, by fax at (305)526-7184, or by telephone at (305)779-6055.

IMPACT ON NATURAL RESOURCES: Preliminary review of this application indicates that an Environmental Impact Statement will not be required. Coordination with U.S. Fish and Wildlife Service, Environmental Protection Agency (EPA), the National Marine Fisheries Services, and other Federal, State, and local agencies, environmental groups, and concerned citizens generally yields pertinent environmental information that is

instrumental in determining the impact the proposed action will have on the natural resources of the area. By means of this notice, we are soliciting comments on the potential effects of the project on threatened or endangered species or their habitat

EVALUATION: The decision whether to issue a permit will be based on an evaluation of the probable impact including cumulative impacts of the proposed activity on the public interest. That decision will reflect the national concern for both protection and utilization of important resources. The benefits, which reasonably may be expected to accrue from the proposal, must be balanced against its reasonably foreseeable detriments. All factors which may be relevant to the proposal will be considered including cumulative impacts thereof; among these are conservation, economics, esthetics, general environmental concerns, wetlands, historical properties, fish and wildlife values, flood hazards, floodplain values, land use, navigation, shoreline erosion and accretion, recreation, water supply and conservation, water quality, energy needs, safety, food, and fiber production, mineral needs, considerations of property ownership, and in general, the needs and welfare of the people. Evaluation of the impact of the activity on the public interest will also include application of the guidelines promulgated by the Administrator, EPA, under authority of Section 404(b) of the Clean Water Act of the criteria established under authority of Section 102(a) of the Marine Protection Research and Sanctuaries Act of 1972. A permit will be granted unless its issuance is found to be contrary to the public interest.

The US Army Corps of Engineers (Corps) is soliciting comments from the public; Federal, State, and local agencies and officials; Indian Tribes; and other Interested parties in order to consider and evaluate the impacts of this proposed activity. Any comments received will be considered by the Corps to determine whether to issue, modify, condition, or deny a permit for this proposal. To make this decision, comments are used to assess impacts on endangered species, historic properties, water quality, general environmental effects, and the other public interest factors listed above. Comments are used in the preparation of an Environmental Assessment and/or an Environmental Impact Statement pursuant to the National Environmental Policy Act comments are also used to determine the need for a public hearing and to determine the overall public interest of the proposed activity.

COASTAL ZONE MANAGEMENT CONSISTENCY: In Florida, the State approval constitutes compliance with the approved Coastal Zone Management Plan. In Puerto Rico, a Coastal Zone Management Consistency Concurrence is required from the Puerto Rico Planning Board, in the Virgin Islands, the Department of Planning and Natural Resources permit constitutes compliance with the Coastal Zone Management Plan.

REQUEST FOR PUBLIC HEARING: Any person may request a public hearing. The request must be submitted in writing to the District Engineer within the designated comment period of the notice and must state the specific reasons for requesting the public hearing.

5TH STREET MARINA SHIPYARD IMPROVEMENTS PROJECT

PROJECT LOCATION, MAPS & LEGAL DESCRIPTION

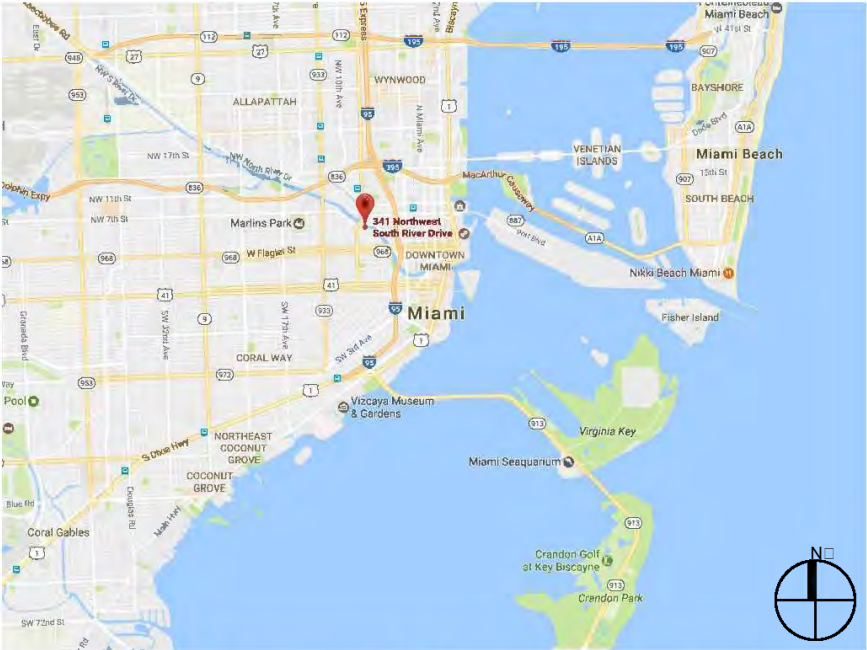

PROJECT SITE LOCATION:
431 NW S RIVER DR.
MIAMI, FLORIDA 33128

LATITUDE: 25°46'41.43"N
LONGITUDE: 80°12'28.38"W

FOLIOS: 01-4138-003-0180,
01-4138-004-0010,
01-4138-003-0170

LEGAL DESCRIPTION:
MULTIPLE LOTS. SEE SURVEY.

INDEX OF DRAWINGS

S-1	COVER SHEET: PROJECT LOCATION & NOTES	S-6	BASIN WALL AND CAP DETAILS
S-2	EXISTING CONDITIONS	S-7	TRAVEL LIFT SECTION
S-3	PROPOSED CONDITIONS	S-8	BASIN DREDGE AND BASIN FILL SECTION
S-4	TYPICAL SEAWALL & RETURN WALL DETAIL & SECTION	S-9	STEEL PANEL, TREMIE SEAL, AND CONTROL JOINT DETAIL
S-5	TRAVEL LIFT BASIN DETAILS		

GENERAL NOTES

- ELEVATIONS SHOWN REFER TO THE NATIONAL GEODETIC VERTICAL DATUM (NGVD) OF 1929.
- ALL DIMENSIONS ON PLANS ARE SUBJECT TO VERIFICATION IN THE FIELD.
- IT IS THE INTENT OF THESE PLANS TO BE IN ACCORDANCE WITH APPLICABLE CODES AND AUTHORITIES HAVING JURISDICTION. ANY DISCREPANCIES BETWEEN THESE PLANS AND APPLICABLE CODES SHALL BE IMMEDIATELY BROUGHT TO THE ATTENTION OF ENGINEER BEFORE PROCEEDING WITH WORK. CONTRACTOR AND ALL SUBCONTRACTORS ARE RESPONSIBLE FOR ALL LINES, ELEVATIONS, AND MEASUREMENTS IN CONNECTION WITH THEIR WORK.
- IT IS THE INTENT OF THESE PLANS AND THE RESPONSIBILITY OF THE CONTRACTOR TO COMPLY WITH LOCAL, STATE, AND FEDERAL ENVIRONMENTAL PERMITS ISSUED FOR THIS PROJECT. IT SHALL BE THE CONTRACTOR'S RESPONSIBILITY TO FAMILIARIZE AND GOVERN HIMSELF BY ALL PROVISIONS OF THESE PERMITS.
- APPLICABLE BUILDING CODE: FLORIDA BUILDING CODE, 2017 EDITION (AND CURRENT ADDENDUMS).
- APPROVED CONTRACTOR TO DETERMINE THE SUITABILITY OF EXISTING STRUCTURES AND VERIFY ALL DIMENSIONS. THE APPROVED CONTRACTOR IS RESPONSIBLE FOR ALL METHODS, MEANS, SEQUENCES AND PROCEDURES OF WORK.
- DO NOT SCALE DRAWINGS FOR DIMENSIONS.
- CONTRACTOR TO VERIFY LOCATION OF EXISTING UTILITIES PRIOR TO COMMENCING WORK.
- CONTRACTOR TO PROPERLY FENCE AND SECURE AREA WITH BARRICADES.
- ANY DEVIATION AND/OR SUBSTITUTION FROM THE INFORMATION PROVIDED HEREIN SHALL BE SUBMITTED TO THE ENGINEER FOR APPROVAL PRIOR TO COMMENCEMENT OF WORK.
- ALL NEW MATERIALS AND/OR PATCHWORK SHALL BE PROVIDED TO MATCH EXISTING MATERIALS AND/OR ADJOINING WORK WHERE PRACTICAL EXCEPT AS SPECIFICALLY NOTED HEREIN.
- LICENSED CONTRACTOR SHALL USE ALL POSSIBLE CARE TO PROTECT ALL EXISTING MATERIALS, SURFACES, AND FURNISHINGS FROM DAMAGE DURING ALL PHASES OF CONSTRUCTION.
- THE LICENSED CONTRACTOR TO INSTALL AND REMOVE ALL SHORING AND BRACING AS REQUIRED FOR THE PROPER EXECUTION OF THE WORK.
- ALL NEW WORK AND/OR MATERIALS SHALL CONFORM TO ALL REQUIREMENTS OF EACH ADMINISTRATIVE BODY HAVING JURISDICTION IN EACH PERTAINING CIRCUMSTANCE.
- THE CONTRACTOR WILL EMPLOY AND MAINTAIN ADEQUATE SEDIMENT AND EROSION CONTROL MEASURES TO PROTECT BISCAYNE BAY FROM SEDIMENT AND CONSTRUCTION DEBRIS.

SHEET PILING NOTES

- STEEL SHEET PILING SHALL BE OF THE SECTIONS INDICATED, AND SHALL BE ASTM A572 GRADE 50.
- SHEET PILING SHALL BE COATED WITH TNEMEC TAR (46H-413) COAL TAR EPOXY; TOP 20', BOTH SIDES EXCEPT AS NOTED.
- COATING SHALL BE 16 MILS DRY FILM THICKNESS, AND APPLIED IN STRICT ACCORDANCE WITH MANUFACTURER INSTRUCTIONS.
- DRIVE SHEET PILING IN ACCORDANCE WITH FDOT 455-9.
- CONTRACTOR SHALL BE PREPARED TO DRIVE SHEET PILING THROUGH LIMESTONE LAYERS; REFER TO GEOTECHNICAL REPORT.
- ANY DAMAGED COATING DUE TO HANDLING, DRIVING, ETC, SHALL BE REPAIRED IN STRICT ACCORDANCE WITH COATING MANUFACTURER INSTRUCTIONS.
- STEEL PILE NOTES
- STEEL PILING SHALL BE OF THE SECTIONS INDICATED, AND SHALL BE ASTM A572 GRADE 50.

CONCRETE

- CONCRETE SHALL CONFORM TO ACI 318 (LATEST ED.) AND SHALL BE REGULAR WEIGHT, SULFATE RESISTANT, WITH A DESIGN STRENGTH OF 5,000 PSI AT 28 DAYS W/ A MAX WATER-CEMENTIOUS MATERIALS RATIO, BY WEIGHT, NORMAL WEIGHT AGGREGATE CONCRETE OF 0.40.
- OWNER SHALL EMPLOY AND PAY FOR TESTING SERVICES FROM AN INDEPENDENT TESTING LABORATORY FOR CONCRETE SAMPLING AND TESTING IN ACCORDANCE W/ ASTM.
- LICENSED CONTRACTOR IS RESPONSIBLE FOR THE ADEQUACY OF FORMS AND SHORING AND FOR SAFE PRACTICE IN THEIR USE AND REMOVAL.
- CONCRETE COVER SHALL BE 3" UNLESS OTHERWISE NOTED ON APPROVED DRAWINGS.
- REINFORCING STEEL SHALL BE IN CONFORMANCE WITH THE LATEST VERSION OF ASTM A615 GRADE 60 SPECIFICATIONS. ALL REINFORCEMENT SHALL BE PLACED IN ACCORDANCE W/ ACI 315 AND ACI MANUAL OF STANDARD PRACTICE.
- SPLICES IN REINFORCING BARS SHALL NOT BE LESS THAN 48 BAR DIAMETERS AND REINFORCING SHALL BE CONTINUOUS AROUND ALL CORNERS AND CHANGES IN DIRECTION. CONTINUITY SHALL BE PROVIDED AT CORNERS OR CHANGES IN DIRECTION BY BENDING THE LONGITUDINAL STEEL AROUND THE CORNER 48 BAR DIAMETERS.

5th STREET MARINA SHIPYARD IMPROVEMENTS PROJECT

Miami, Florida

CLIENT:
5TH ST MARINA, LLC
C/O MR. ORIN BLACK
341 NW South Rive Drive
Miami, FL 33128

ENVIRONMENTAL CONSULTANT:
OCEAN CONSULTING, LLC
340 Minorca Avenue, Suite 7
Coral Gables, Florida 33134
Tel: (305) 921-9344
Fax: (305) 677-3254

CONTRACTOR:

PROJECT ENGINEER:
SOLVER STRUCTURAL PARTNERSHIP INC.
950 N.W 22nd Ave
Miami, Florida 33125
Office - (305) 643-8699
Fax - (305) 643- 8692

Deni K. Solano
P.E. 56902 S.I. 2046 C.O.A. 00009095

Issue #	Issue Date
Nov. 22, 2019	

PROJECT LOCATION & NOTES

SCALE : AS SHOWN
PERMIT DRAWINGS
PROJECT: 17-6360
CLI-2017-0197

SHEET NO.
S-1

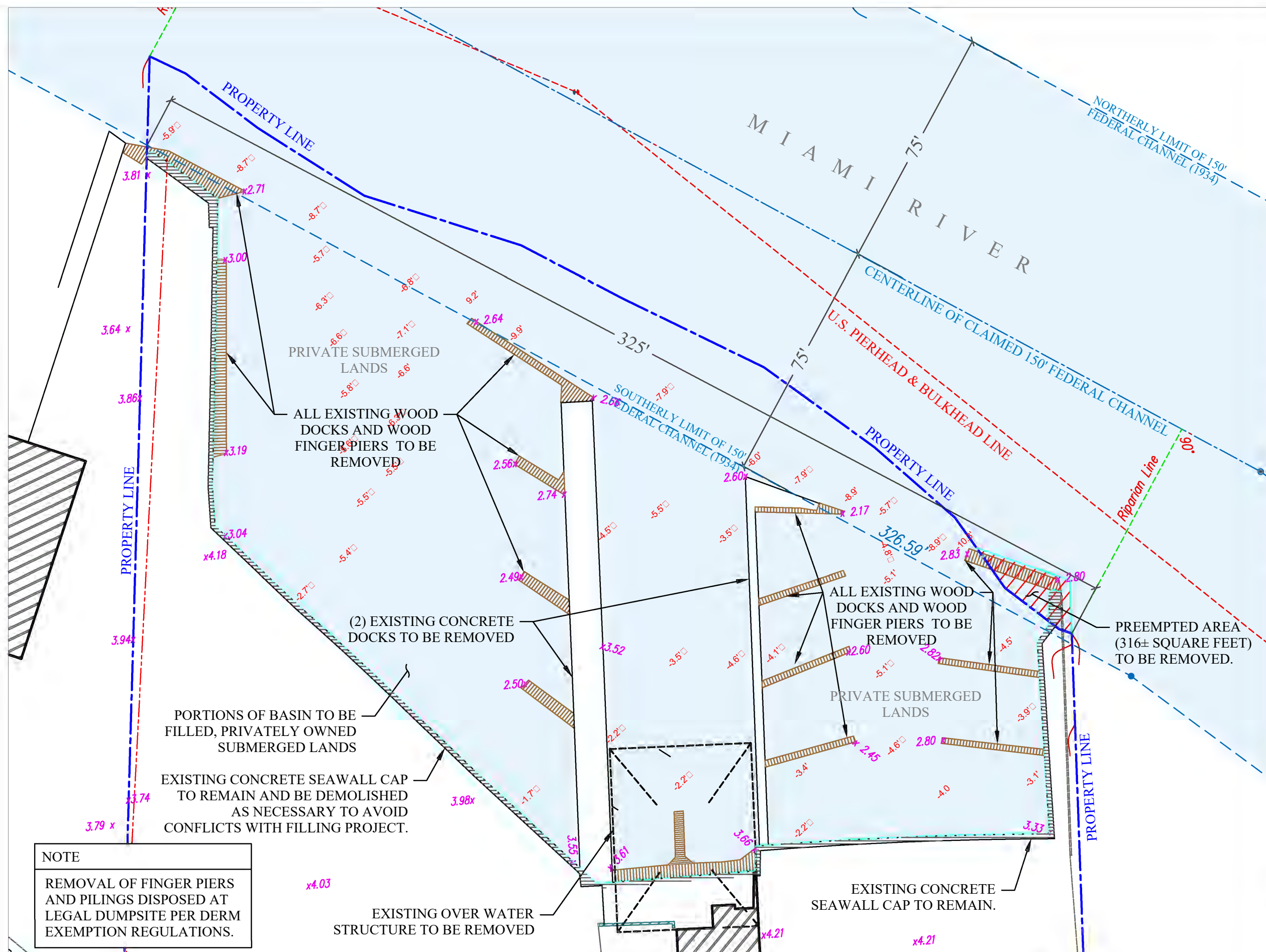

NOTE

REMOVAL OF FINGER PIERS AND PILINGS DISPOSED AT LEGAL DUMPSITE PER DERM EXEMPTION REGULATIONS.

EXISTING CONDITIONS

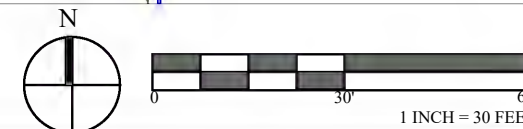

5th STREET MARINA SHIPYARD IMPROVEMENTS PROJECT

Miami, Florida

5TH ST MARINA, LLC
C/O MR. ORIN BLACK
341 NW South Rive Drive
Miami, FL 33128

ENVIRONMENTAL CONSULTANT:
OCEAN CONSULTING, LLC

340 Minorca Avenue, Suite 7 Tel: (305) 921-9344
Coral Gables, Florida 33134 Fax: (305) 677-3254

CONTRACTOR:

PROJECT ENGINEER:
SOLVER STRUCTURAL PARTNERSHIP INC.
950 N.W 22nd Ave Office - (305) 643-8699
Miami, Florida 33125 Fax - (305) 643- 8692

Deni K. Solano
P.E. 56902 S.I. 2046 C.O.A. 00009095

Issue # Issue Date

① Nov. 22, 2019

EXISTING CONDITIONS

SCALE : AS SHOWN

PERMIT DRAWINGS

PROJECT: 17-6360
CLI-2017-0197

SHEET NO.

S-2

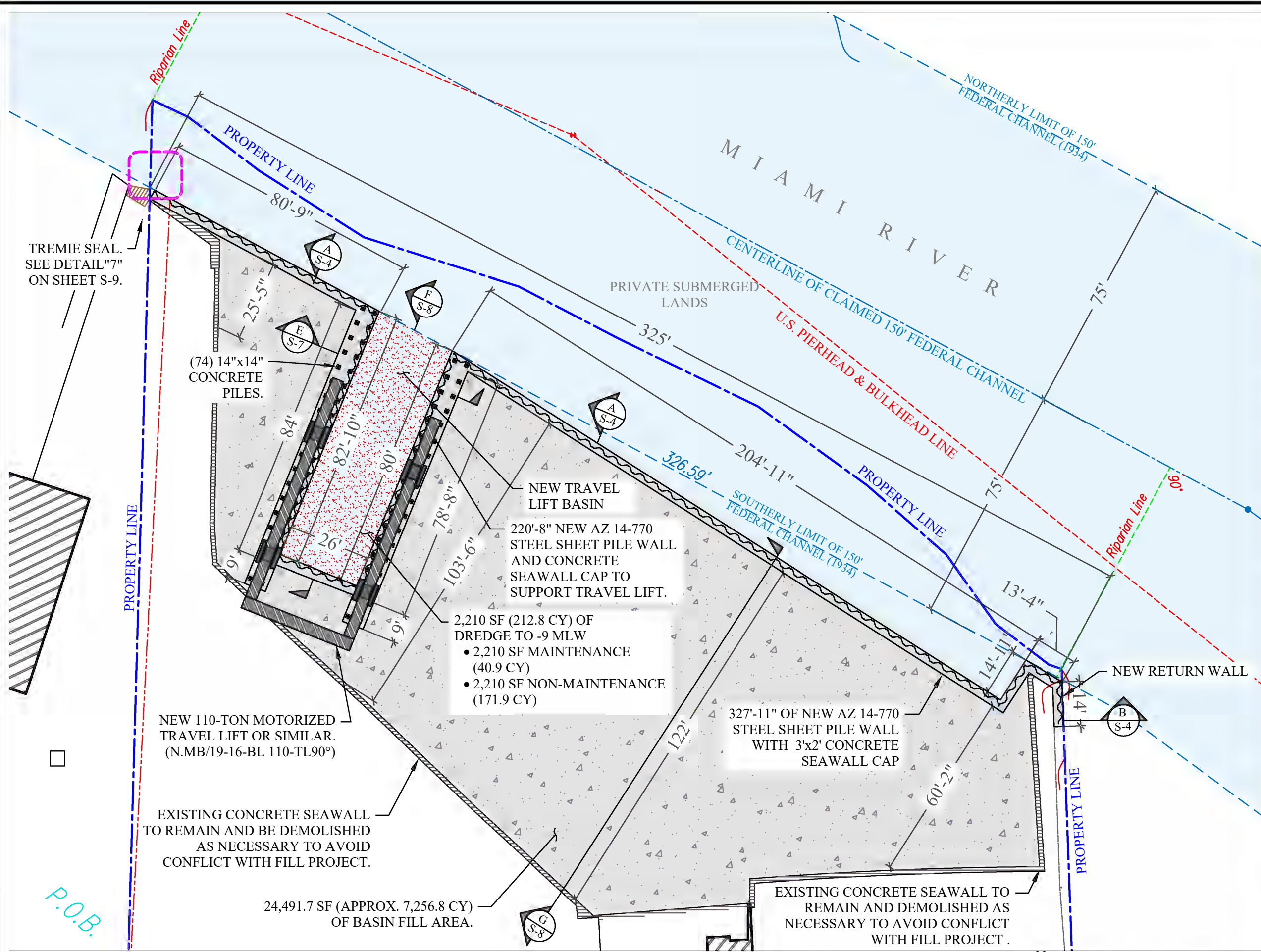

5th STREET MARINA SHIPYARD IMPROVEMENTS PROJECT

Miami, Florida

5TH ST MARINA, LLC
C/O MR. ORIN BLACK
341 NW South Rive Drive
Miami, FL 33128

ENVIRONMENTAL CONSULTANT:
OCEAN CONSULTING, LLC

340 Minorca Avenue, Suite 7 Tel: (305) 921-9344
Coral Gables, Florida 33134 Fax: (305) 677-3254

CONTRACTOR:

PROJECT ENGINEER:
SOLVER STRUCTURAL PARTNERSHIP INC.
950 N.W 22nd Ave Office - (305) 643-8699
Miami, Florida 33125 Fax - (305) 643- 8692

Deni K. Solano
P.E. 56902 S.I. 2046 C.O.A. 00009095

Issue # Issue Date

1 Nov. 22, 2019

PROPOSED CONDITIONS

SCALE : AS SHOWN

PERMIT DRAWINGS

PROJECT: 17-6360
CLI-2017-0197

SHEET NO.

S-3

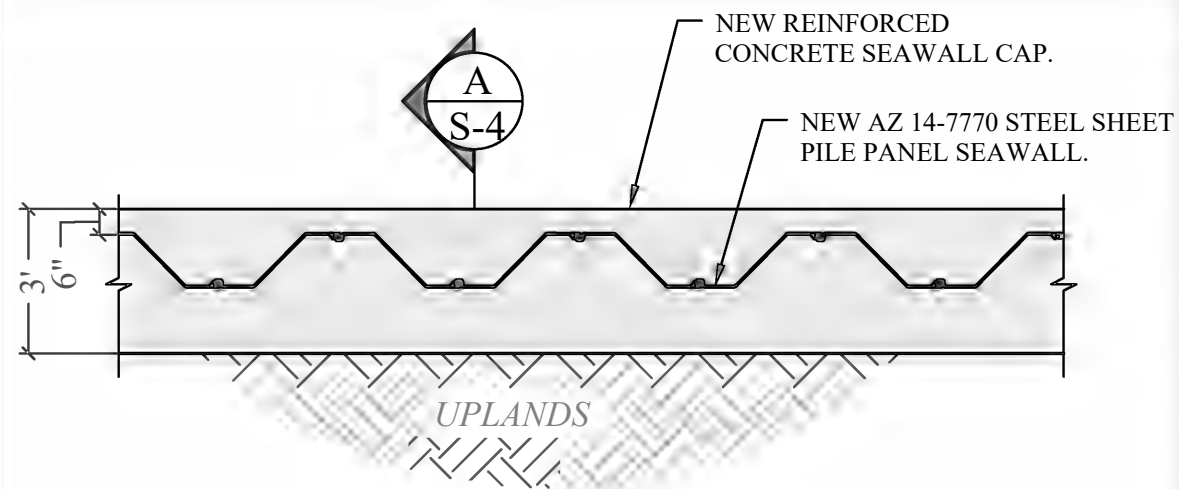

PROPOSED SEAWALL DETAILS

1
S-4

SCALE: 1/4" = 1'-0"

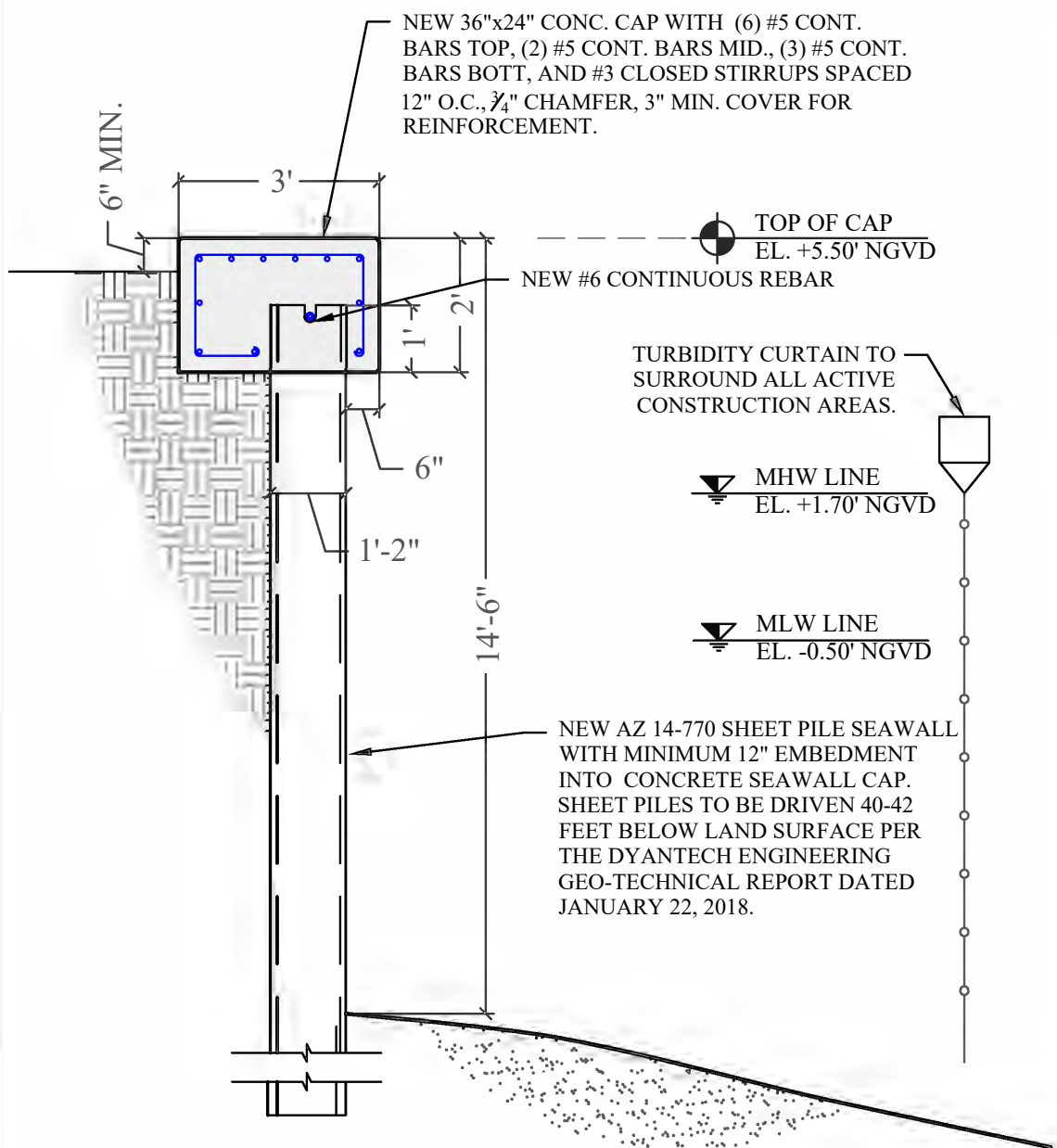

TYPICAL SEAWALL SECTION

A
S-4

SCALE: 3/8" = 1'-0"

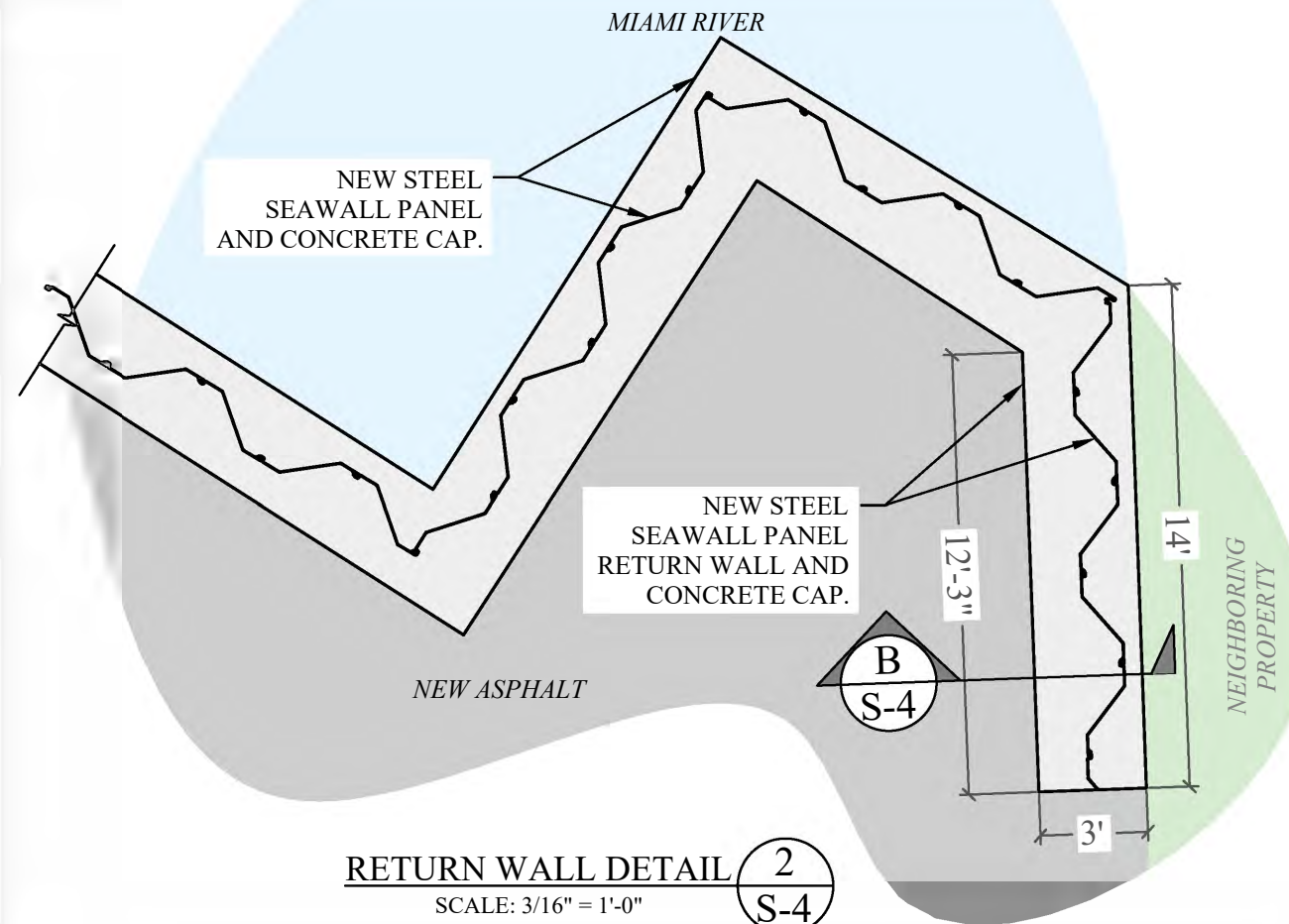

RETURN WALL DETAIL

2
S-4

SCALE: 3/16" = 1'-0"

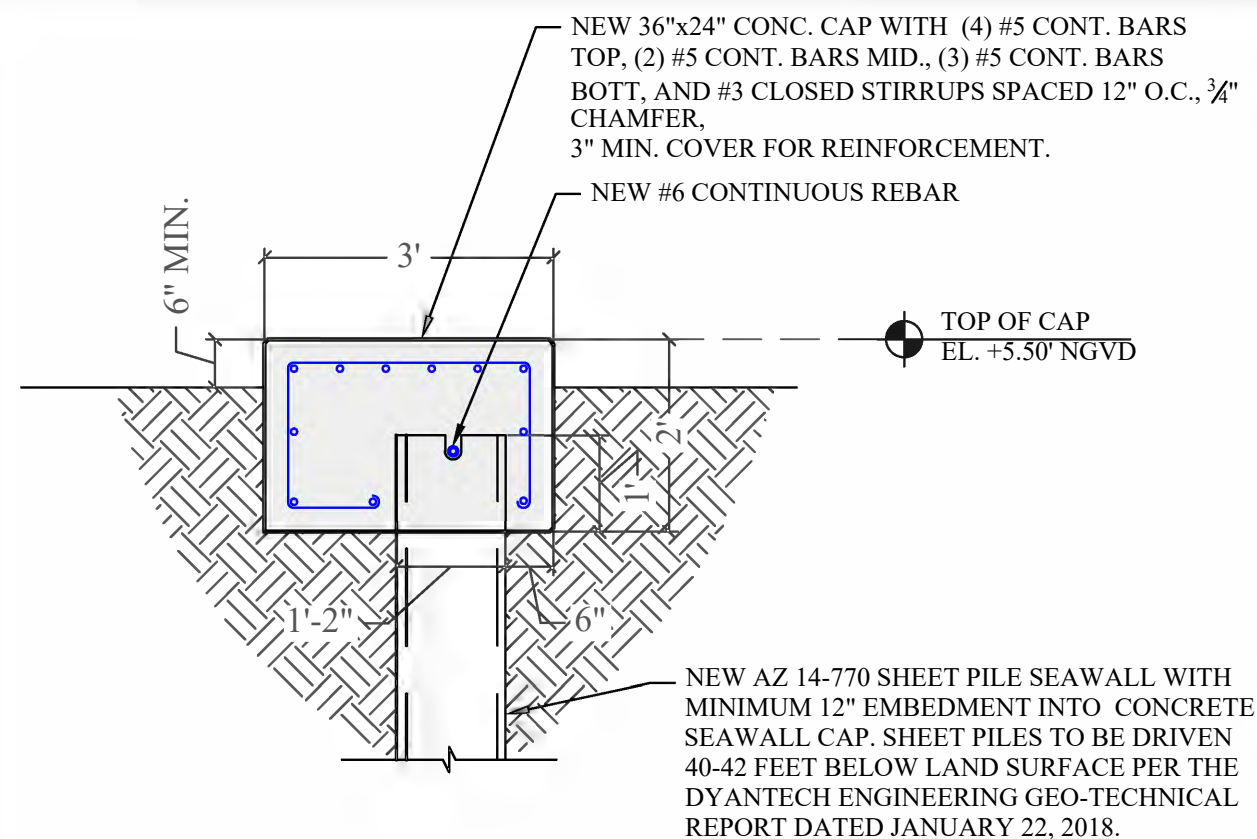

RETAINING WALL SECTION

B
S-4

SCALE: 1/2" = 1'-0"

5th STREET MARINA SHIPYARD IMPROVEMENTS PROJECT

Miami, Florida

5TH ST MARINA, LLC
C/O MR. ORIN BLACK
341 NW South Rive Drive
Miami, FL 33128

ENVIRONMENTAL CONSULTANT:
OCEAN CONSULTING, LLC

340 Minorca Avenue, Suite 7 Tel: (305) 921-9344
Coral Gables, Florida 33134 Fax: (305) 677-3254

CONTRACTOR:

PROJECT ENGINEER:
SOLVER STRUCTURAL PARTNERSHIP INC.
950 N.W 22nd Ave Office - (305) 643-8699
Miami, Florida 33125 Fax - (305) 643- 8692

Deni K. Solano
P.E. 56902 S.I. 2046 C.O.A. 00009095

Issue # Issue Date

1 Nov. 22, 2019

**SEAWALL SECTION, SHEET
PILE SPECS, & CONTROL JOINT**
SCALE : AS SHOWN

PERMIT DRAWINGS

SHEET NO.

PROJECT: 17-6360
CLI-2017-0197

S-4

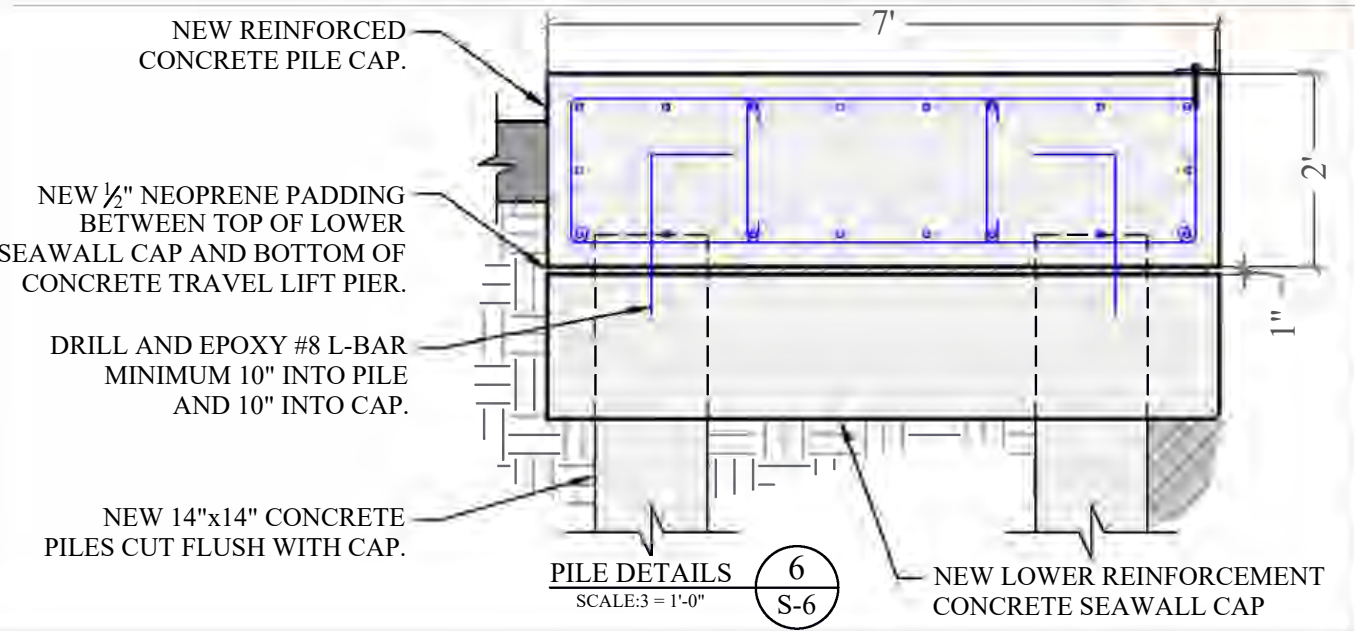
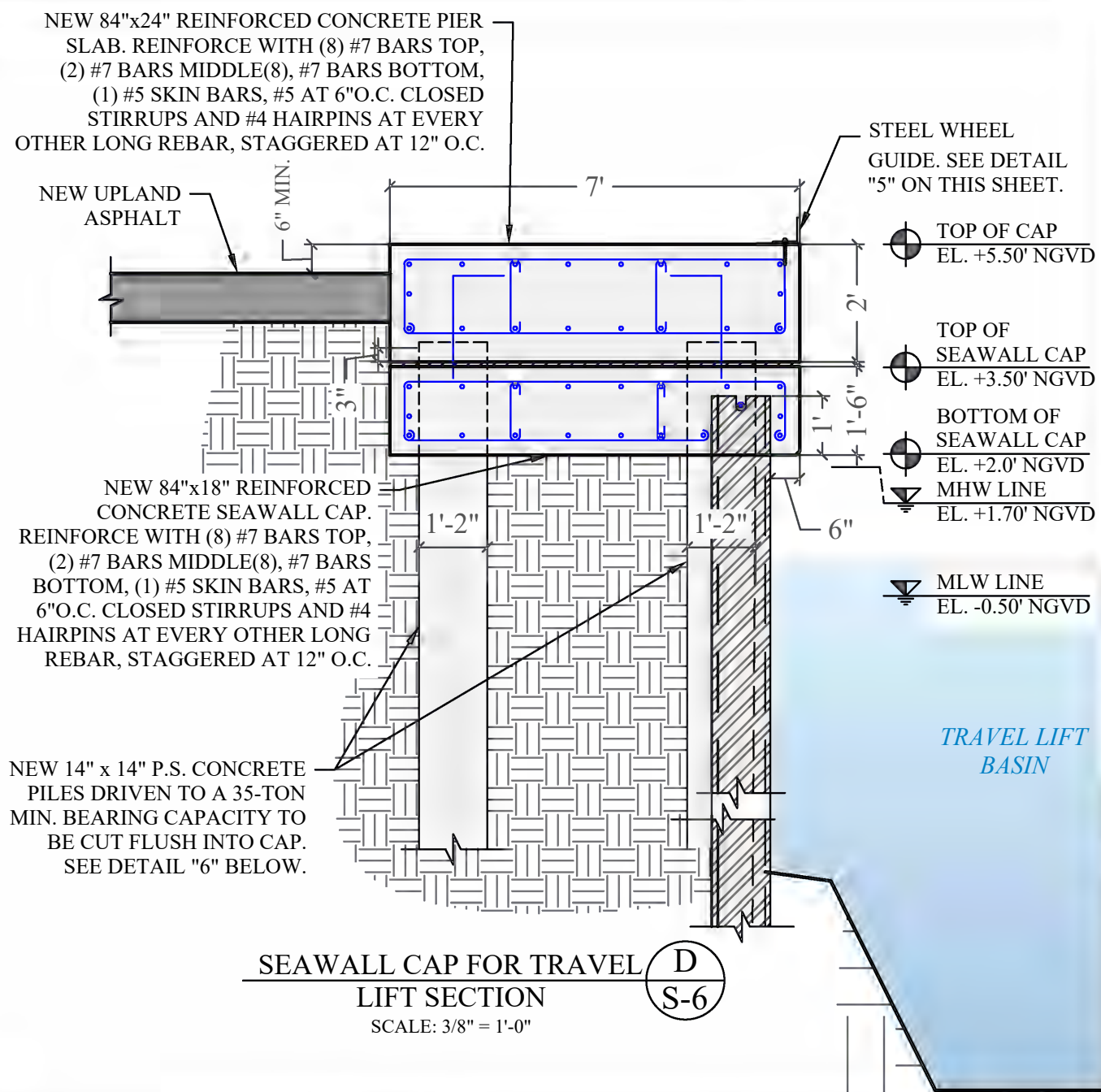
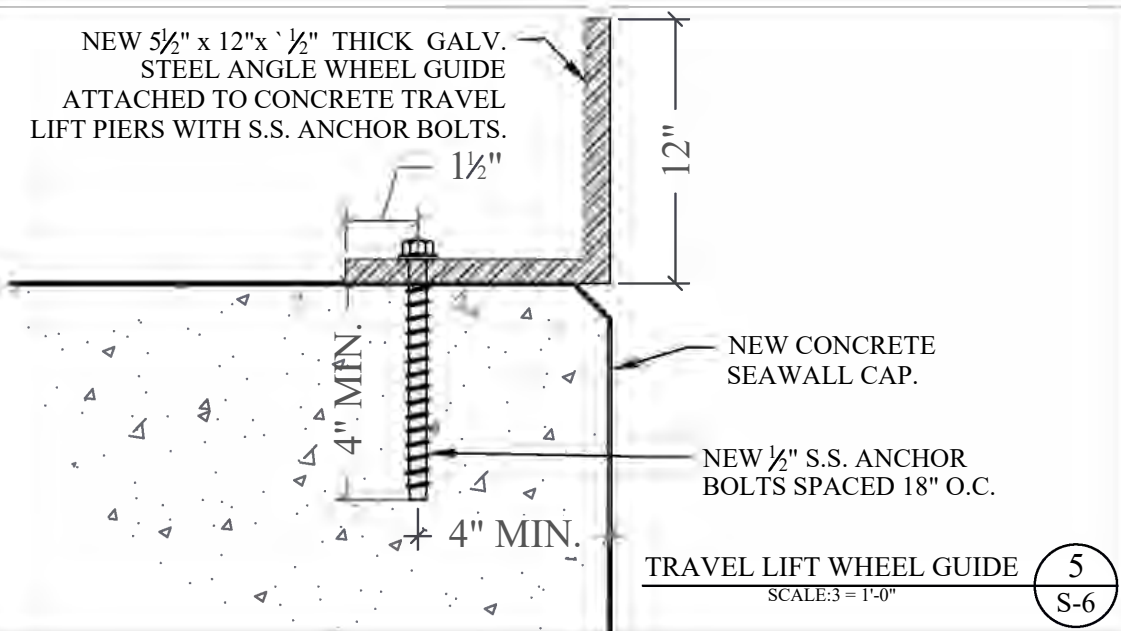
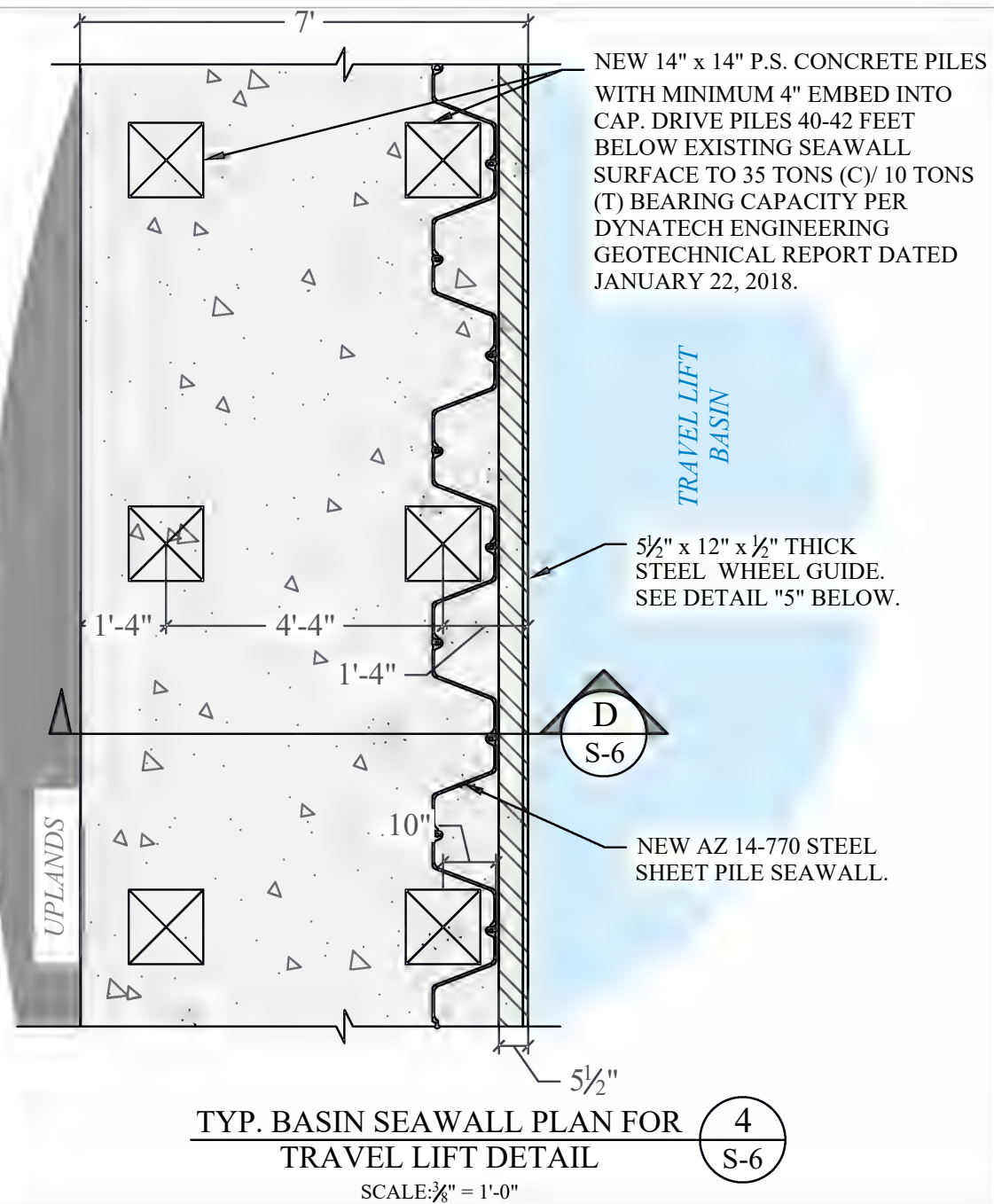

5th STREET MARINA SHIPYARD IMPROVEMENTS PROJECT

Miami, Florida

5TH ST MARINA, LLC
C/O MR. ORIN BLACK
341 NW South Rive Drive
Miami, FL 33128

ENVIRONMENTAL CONSULTANT:
OCEAN CONSULTING, LLC

340 Minorca Avenue, Suite 7
Coral Gables, Florida 33134

Tel: (305) 921-9344
Fax: (305) 677-3254

CONTRACTOR:

PROJECT ENGINEER:
SOLVER STRUCTURAL PARTNERSHIP INC.
950 N.W 22nd Ave
Miami, Florida 33125

Office - (305) 643-8699
Fax - (305) 643- 8692

Deni K. Solano
P.E. 56902 S.I. 2046 C.O.A. 00009095

Issue # Issue Date

1 Nov. 22, 2019

BASIN WALL AND CAP DETAILS

SCALE : AS SHOWN

PERMIT DRAWINGS

PROJECT: 17-6360
CLI-2017-0197

SHEET NO.

S-6

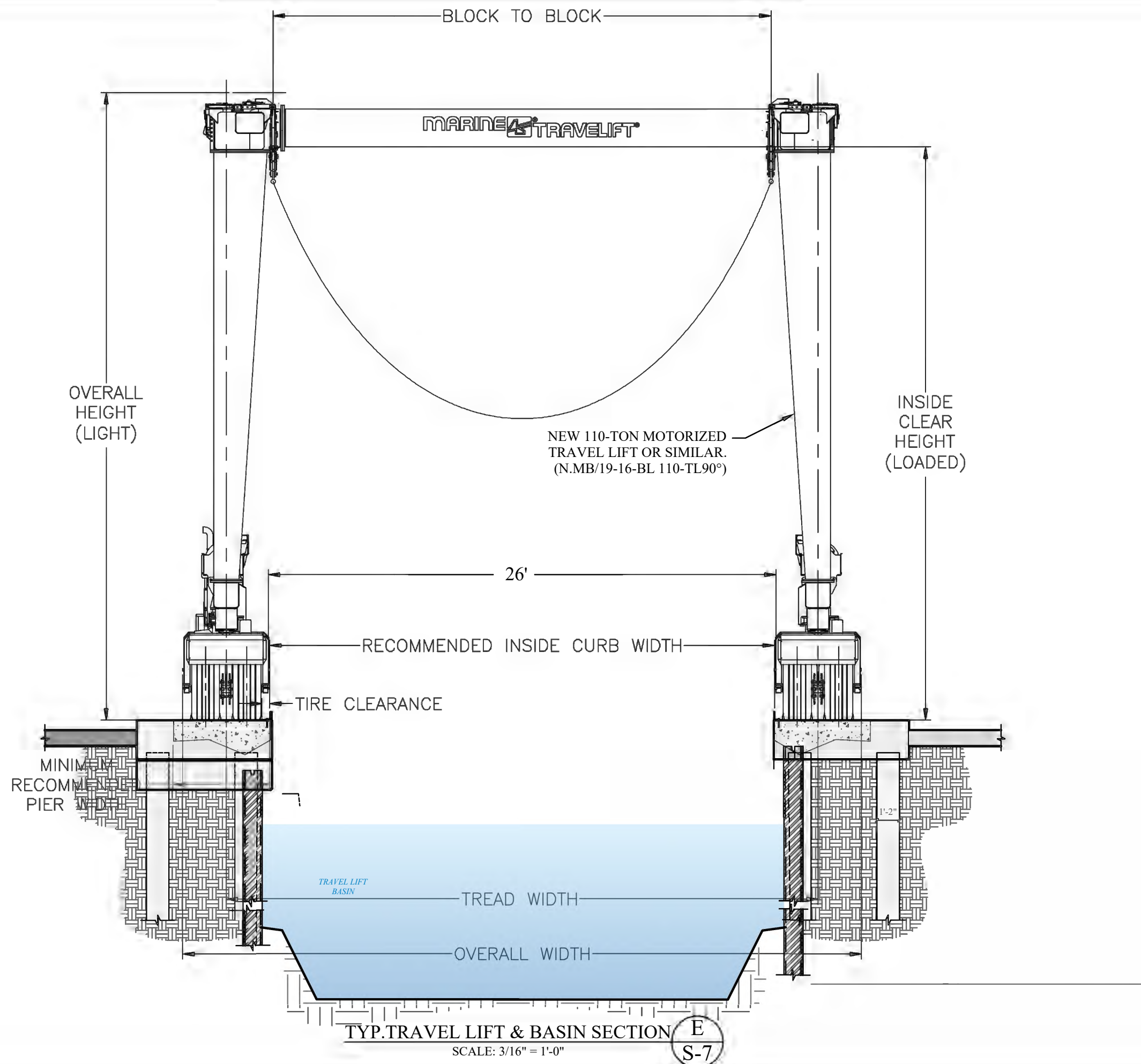

5th STREET MARINA SHIPYARD IMPROVEMENTS PROJECT

Miami, Florida

5TH ST MARINA, LLC
C/O MR. ORIN BLACK
 341 NW South Rive Drive
 Miami, FL 33128

ENVIRONMENTAL CONSULTANT:
OCEAN CONSULTING, LLC

340 Minorca Avenue, Suite 7 Tel: (305) 921-9344
 Coral Gables, Florida 33134 Fax: (305) 677-3254

CONTRACTOR:

PROJECT ENGINEER:
SOLVER STRUCTURAL PARTNERSHIP INC.
 950 N.W 22nd Ave Office - (305) 643-8699
 Miami, Florida 33125 Fax - (305) 643- 8692

Deni K. Solano
 P.E. 56902 S.I. 2046 C.O.A. 00009095

Issue # Issue Date

① Nov. 22, 2019

**TRAVEL LIFT AND
BASIN SECTION**

SCALE : AS SHOWN

PERMIT DRAWINGS

PROJECT: 17-6360
 CLI-2017-0197

SHEET NO.

S-7

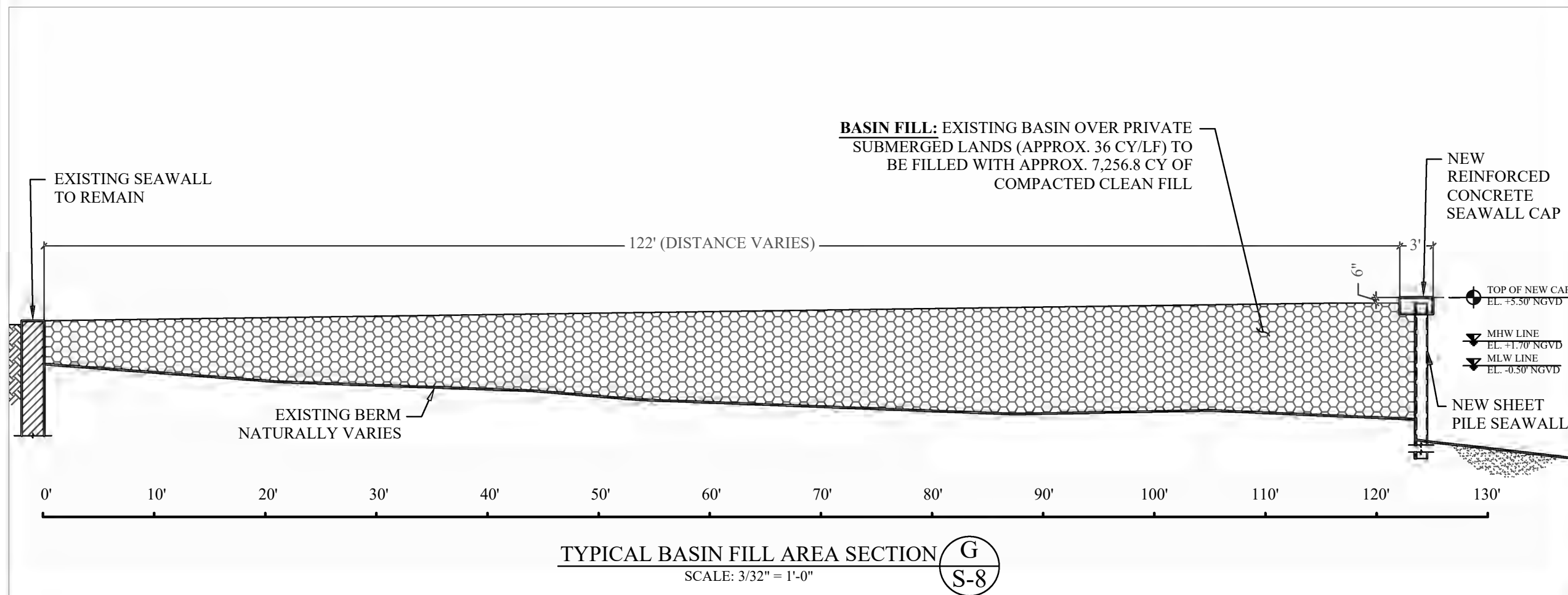
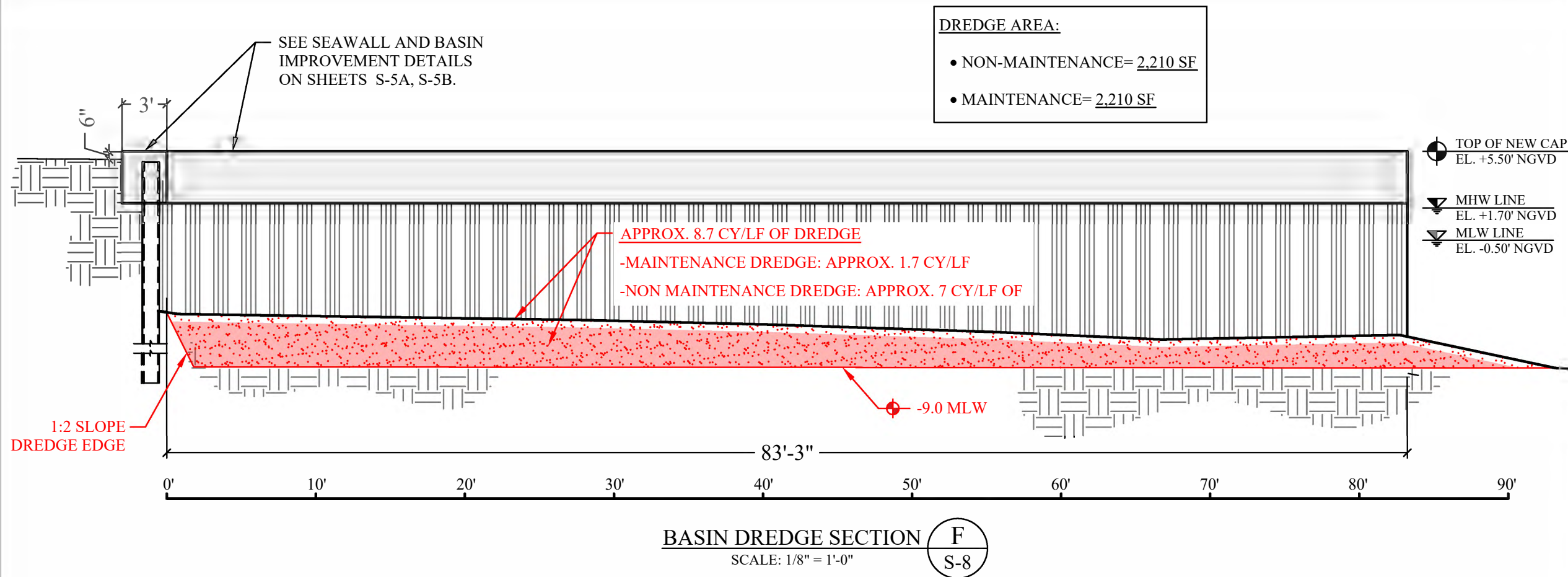

5th STREET MARINA SHIPYARD IMPROVEMENTS PROJECT

Miami, Florida

5TH ST MARINA, LLC
C/O MR. ORIN BLACK
341 NW South Rive Drive
Miami, FL 33128

ENVIRONMENTAL CONSULTANT:
OCEAN CONSULTING, LLC

340 Minorca Avenue, Suite 7 Tel: (305) 921-9344
Coral Gables, Florida 33134 Fax: (305) 677-3254

CONTRACTOR:

PROJECT ENGINEER:
SOLVER STRUCTURAL PARTNERSHIP INC.
950 N.W 22nd Ave Office - (305) 643-8699
Miami, Florida 33125 Fax - (305) 643- 8692

Deni K. Solano
P.E. 56902 S.I. 2046 C.O.A. 00009095

Issue # Issue Date

1 Nov. 22, 2019

**BASIN DREDGE SECTION
& TYPICAL BASIN FILL**

SCALE : AS SHOWN

PERMIT DRAWINGS

PROJECT: 17-6360
CLI-2017-0197

SHEET NO.

S-8

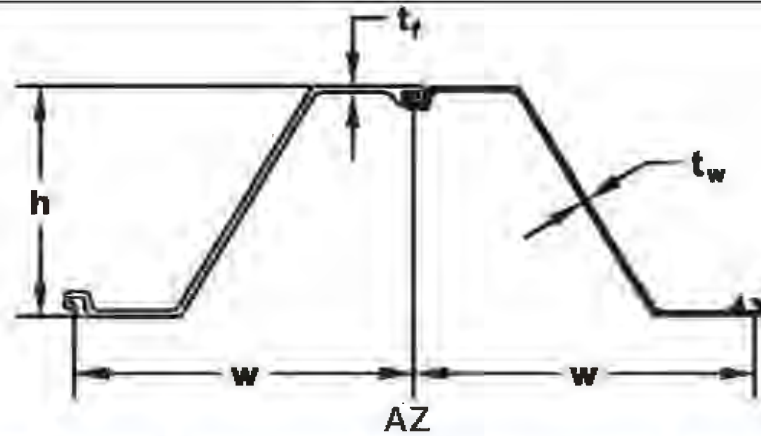

SECTION	Width (w) in (mm)	Height (h) in (mm)	THICKNESS		Cross Sectional Area in ² /ft (cm ² /m)	WEIGHT		Section Modulus in ³ /ft (cm ³ /m)	Moment of Inertia in ⁴ /ft (cm ⁴ /m)	COATING AREA	
			Flange (t _f) in (mm)	Web (t _w) in (mm)		Pile lb/ft (kg/m)	Wall lb/ft ² (kg/m ²)			Both Sides ft ² /ft of single (m ² /m)	Wall Surface ft ² /ft ² (m ² /m ²)
AZ 14-770	30.31 770	13.56 344.5	0.375 9.50	0.375 9.50	6.21 131.5	53.42 79.50	21.14 103.20	25.2 1355	170.6 23300	6.10 1.86	1.20 1.20

STEEL SHEET PILE SPECIFICATIONS 7
S-9
NOT DRAWN TO SCALE

**5th STREET MARINA
SHIPYARD IMPROVEMENTS
PROJECT**
Miami, Florida

5TH ST MARINA, LLC
C/O MR. ORIN BLACK
341 NW South Rive Drive
Miami, FL 33128

ENVIRONMENTAL CONSULTANT:
OCEAN CONSULTING, LLC
340 Minorca Avenue, Suite 7 Tel: (305) 921-9344
Coral Gables, Florida 33134 Fax: (305) 677-3254

CONTRACTOR:

PROJECT ENGINEER:
SOLVER STRUCTURAL PARTNERSHIP INC.
950 N.W 22nd Ave Office - (305) 643-8699
Miami, Florida 33125 Fax - (305) 643- 8692

Deni K. Solano
P.E. 56902 S.I. 2046 C.O.A. 00009095

Issue # Issue Date
① Nov. 22, 2019

**STEEL PANEL, TREMIE SEAL,
AND CONTROL JOINT DETAIL**
SCALE : AS SHOWN

PERMIT DRAWINGS SHEET NO.
S-9
PROJECT: 17-6360
CLI-2017-0197

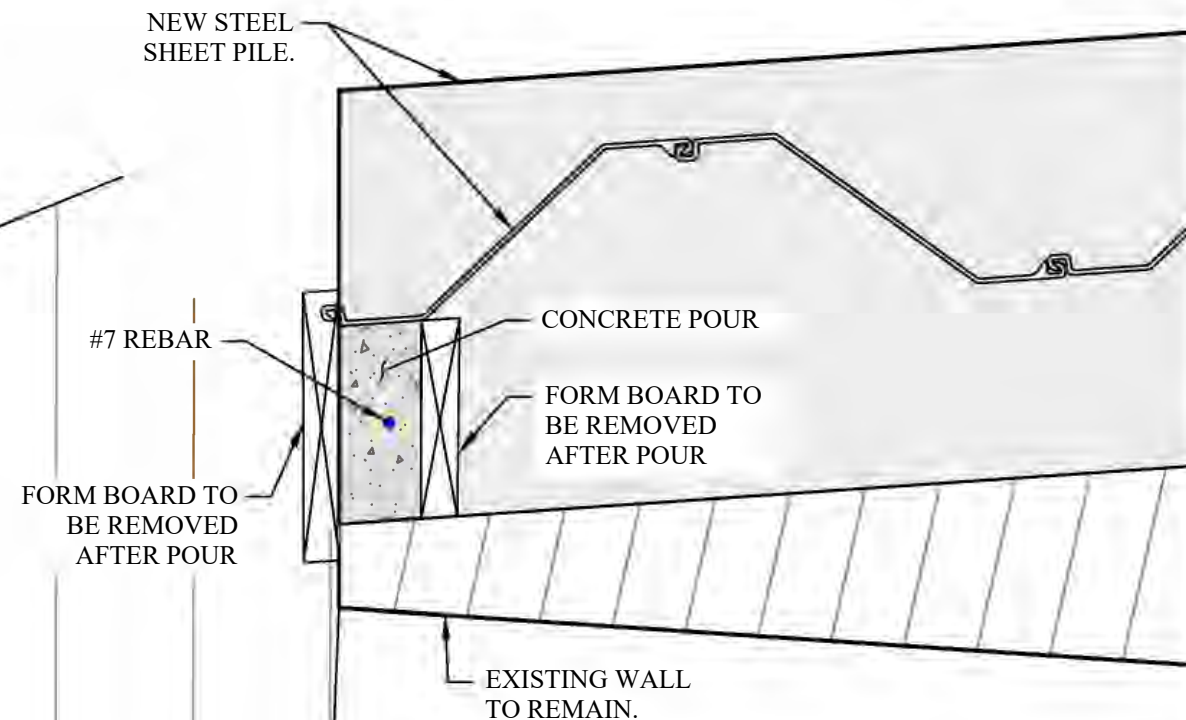

TREMIE SEAL DETAIL 8
S-9
NOT DRAWN TO SCALE

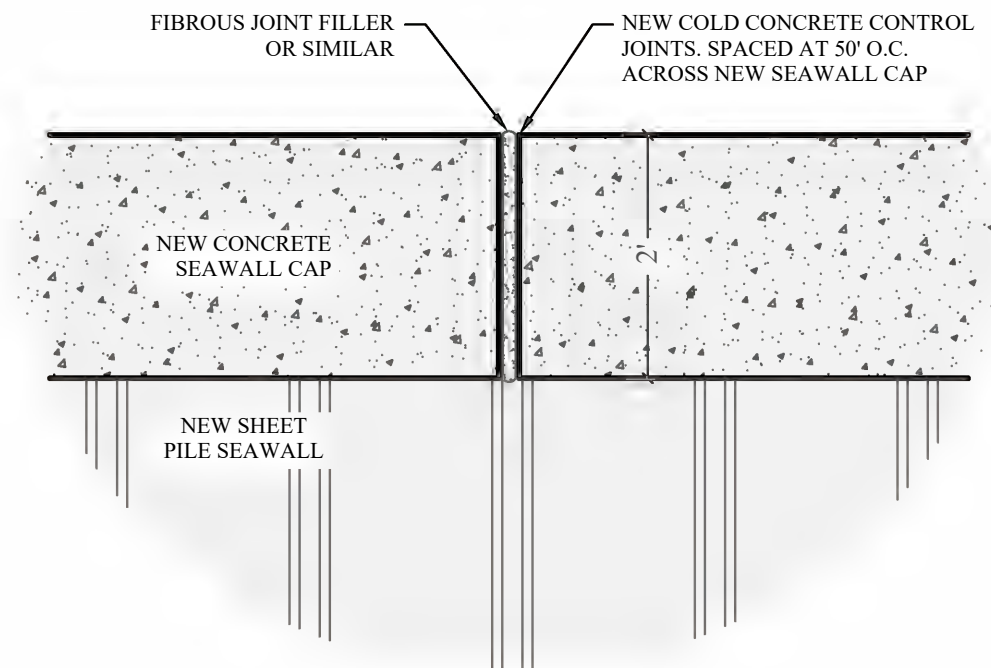

CONCRETE CONTROL JOINT DETAIL 9
S-9
NOT DRAWN TO SCALE