



DEPARTMENT OF THE ARMY
CORPS OF ENGINEERS, JACKSONVILLE DISTRICT
701 SAN MARCO BOULEVARD
JACKSONVILLE, FLORIDA 32207-8915

June 8, 2020

REPLY TO
ATTENTION OF

Regulatory Division
North Permits Branch
Pensacola Permits Section

PUBLIC NOTICE

Permit Application No. SAJ-2019-02898 (SP-EPS)

TO WHOM IT MAY CONCERN: The Jacksonville District of the U.S. Army Corps of Engineers (Corps) has received an application for a Department of the Army permit pursuant to Section 404 of the Clean Water Act (33 U.S.C. §1344) as described below:

APPLICANT: School District of Escambia County
c/o Anthony Noles
30 East Texar Drive
Pensacola, FL 32503

WATERWAY AND LOCATION: The project would affect waters of the United States associated with Perdido Bay. The project site is located at 10789 Sorrento Road, Pensacola, Florida 32507.

Directions to the site are as follows: From downtown Pensacola, take Garden Street west to Barrancas Avenue for approximately 3 miles. Continue straight onto Gulf Beach Highway/FL 297 and then Sorrento Road/Hwy 292 for approximately 5.6 miles. Project site is located on the south side of the road, approximately 0.69 miles west of the intersection of Sorrento Road and Blue Angel Parkway.

APPROXIMATE CENTRAL COORDINATES: Latitude 30.354895°
Longitude -87.368533°

PROJECT PURPOSE:

Basic: Increased student capacity.

Overall: To increase the elementary school student capacity for southwest Pensacola / southwest Escambia County.

EXISTING CONDITIONS: The 28.78-acres of onsite wetlands are primarily a fire-suppressed, palustrine forested/shrub system. The vegetation consists of black titi (*Cliftonia monophylla*), red titi (*Cyrilla racemiflora*), slash pine (*Pinus elliottii*), sweetbay magnolia (*Magnolia virginiana*), Ilex myrtifolia, fetterbush (*Lyonia lucida*) gallberry (*Ilex glabra*), bog buttons, wiregrass, and various ferns. Most of the 38.23 acres of uplands on the site have been cleared, with varying degrees of vegetative cover existing now. Three excavated ponds onsite total 0.97-acre. The proposed fill discharge would be

adjacent to an existing fill road currently providing access from Sorrento Road. The area surrounding the project site consists of undeveloped wetlands and uplands, and some light residential and commercial development.

PROPOSED WORK: The applicant seeks authorization to impact 0.62-acres of wetlands for an access road to a new public elementary school sited entirely in uplands.

AVOIDANCE AND MINIMIZATION INFORMATION – The applicant has provided the following information in support of efforts to avoid and/or minimize impacts to the aquatic environment:

Out of 28.78 acres of wetlands, impacts will be: wetland is 0.60 acres (access road), surface water is 0.02 acres (access road), and wetland buffer impacts are 0.66 acres for access road/entry off Sorrento Road. The District has not found any other viable upland option that would have less wetland impacts than the current proposed design, see Alternative Analysis package. The sole entrance must be from the north, as the County will not allow access from the south along Etheridge Road. There is no other viable upland access. As the sole entrance is from the north, the main entrance must be 40' wide with sidewalks and grading at a safe 3:1. The main access point will be within the footprint of an existing dirt road and a series of five (5), 24" RCP culvert cross/underdrains will be placed under the road (there are presently no culverts).

COMPENSATORY MITIGATION – The applicant has offered the following compensatory mitigation plan to offset unavoidable functional loss to the aquatic environment:

To offset for 0.62 acres of wetland and surface water impacts, the applicant proposes to preserve the majority of the remaining onsite wetlands in a perpetual conservation easement. The onsite area proposed for preservation is 26.45 acres of wetlands and 2.73 acres of uplands.

CULTURAL RESOURCES:

The Corps is not aware of any known historic properties within the permit area. By copy of this public notice, the Corps is providing information for review. Our final determination relative to historic resource impacts is subject to review by and coordination with the State Historic Preservation Officer and those federally recognized tribes with concerns in Florida and the Permit Area.

ENDANGERED SPECIES:

The Corps has determined the proposal may affect, but is not likely to adversely affect the eastern indigo snake (*Drymarchon couperi*). The Corps has determined the proposal would have no effect on any other listed threatened or endangered species or designated critical habitat.

ESSENTIAL FISH HABITAT (EFH): This notice initiates consultation with the National Marine Fisheries Service on EFH as required by the Magnuson-Stevens Fishery Conservation and Management Act 1996. The proposal would impact approximately 0.60-acre of palustrine wetlands and 0.02-acre of lacustrine wetlands hydrologically connected to tidal waters utilized by various life stages of shrimp, reef fish, red drum, and coastal migratory/pelagic fish. Our initial determination is that the proposed action would not have a substantial adverse impact on EFH or Federally-managed fisheries in the Gulf of Mexico. Our final determination relative to project impacts and the need for mitigation measures is subject to review by and coordination with the National Marine Fisheries Service.

NOTE: This public notice is being issued based on information furnished by the applicant. This information has not been verified or evaluated to ensure compliance with laws and regulation governing the regulatory program. The jurisdictional line has been verified by Corps personnel.

AUTHORIZATION FROM OTHER AGENCIES: Water Quality Certification may be required from the Florida Department of Environmental Protection and/or one of the state Water Management Districts.

COMMENTS regarding the potential authorization of the work proposed should be submitted in writing to the attention of the District Engineer through the Pensacola Permits Section, 41 North Jefferson Street, Suite 301, Pensacola, Florida 32502 within 21 days from the date of this notice.

The decision whether to issue or deny this permit application will be based on the information received from this public notice and the evaluation of the probable impact to the associated wetlands. This is based on an analysis of the applicant's avoidance and minimization efforts for the project, as well as the compensatory mitigation proposed.

QUESTIONS concerning this application should be directed to the project manager, Ed Sarfert, in writing at the Pensacola Permits Section, 41 N. Jefferson Street, Pensacola, FL 32502; by electronic mail at edward.p.sarfert@usace.army.mil; by facsimile transmission at (850)433-8160; or, by telephone at (850)439-9533.

IMPACT ON NATURAL RESOURCES: Coordination with U.S. Fish and Wildlife Service, Environmental Protection Agency (EPA), the National Marine Fisheries Services, and other Federal, State, and local agencies, environmental groups, and concerned citizens generally yields pertinent environmental information that is instrumental in determining the impact the proposed action will have on the natural resources of the area.

EVALUATION: The decision whether to issue a permit will be based on an evaluation of the probable impact including cumulative impacts of the proposed activity on the public interest. That decision will reflect the national concern for both protection and utilization of important resources. The benefits, which reasonably may be expected to accrue from the proposal, must be balanced against its reasonably foreseeable detriments. All

factors which may be relevant to the proposal will be considered including cumulative impacts thereof; among these are conservation, economics, esthetics, general environmental concerns, wetlands, historical properties, fish and wildlife values, flood hazards, floodplain values, land use, navigation, shoreline erosion and accretion, recreation, water supply and conservation, water quality, energy needs, safety, food, and fiber production, mineral needs, considerations of property ownership, and in general, the needs and welfare of the people. Evaluation of the impact of the activity on the public interest will also include application of the guidelines promulgated by the Administrator, EPA, under authority of Section 404(b) of the Clean Water Act or the criteria established under authority of Section 102(a) of the Marine Protection Research and Sanctuaries Act of 1972. A permit will be granted unless its issuance is found to be contrary to the public interest.

The US Army Corps of Engineers (Corps) is soliciting comments from the public; Federal, State, and local agencies and officials; Indian Tribes; and other Interested parties in order to consider and evaluate the impacts of this proposed activity. Any comments received will be considered by the Corps to determine whether to issue, modify, condition, or deny a permit for this proposal. To make this determination, comments are used to assess impacts to endangered species, historic properties, water quality, general environmental effects, and the other public interest factors listed above. Comments are also used to determine the need for a public hearing and to determine the overall public interest of the proposed activity.

COASTAL ZONE MANAGEMENT CONSISTENCY: In Florida, the State approval constitutes compliance with the approved Coastal Zone Management Plan. In Puerto Rico, a Coastal Zone Management Consistency Concurrence is required from the Puerto Rico Planning Board. In the Virgin Islands, the Department of Planning and Natural Resources permit constitutes compliance with the Coastal Zone Management Plan.

REQUEST FOR PUBLIC HEARING: Any person may request a public hearing. The request must be submitted in writing to the District Engineer within the designated comment period of the notice and must state the specific reasons for requesting the public hearing.



EXHIBIT 1
SITE LOCATION MAP
SORRENTO ROAD
13-35-31-2301-000-000
KENNETH HORNE & ASSOCIATES

LEGEND
 INSPECTION BOUNDARY

4/26/2019

AUTHOR: CBO

THIS IS NOT A SURVEY



0 1,500 3,000
 Feet

biome
 Consulting Group
 1300 West Government St. Pensacola, FL 32502
 850.435.9167 www.biome.co



EXHIBIT 3
AERIAL IMAGERY
SORRENTO ROAD
13-3S-31-2301-000-000
KENNETH HORNE & ASSOCIATES

LEGEND
[Red Outline] INSPECTION BOUNDARY

4/26/2019

AUTHOR: CBO

THIS IS NOT A SURVEY

0 300 600
Feet



biome
Consulting Group
1300 West Government St. Pensacola, FL 32502
850.435.9367 www.biome.co

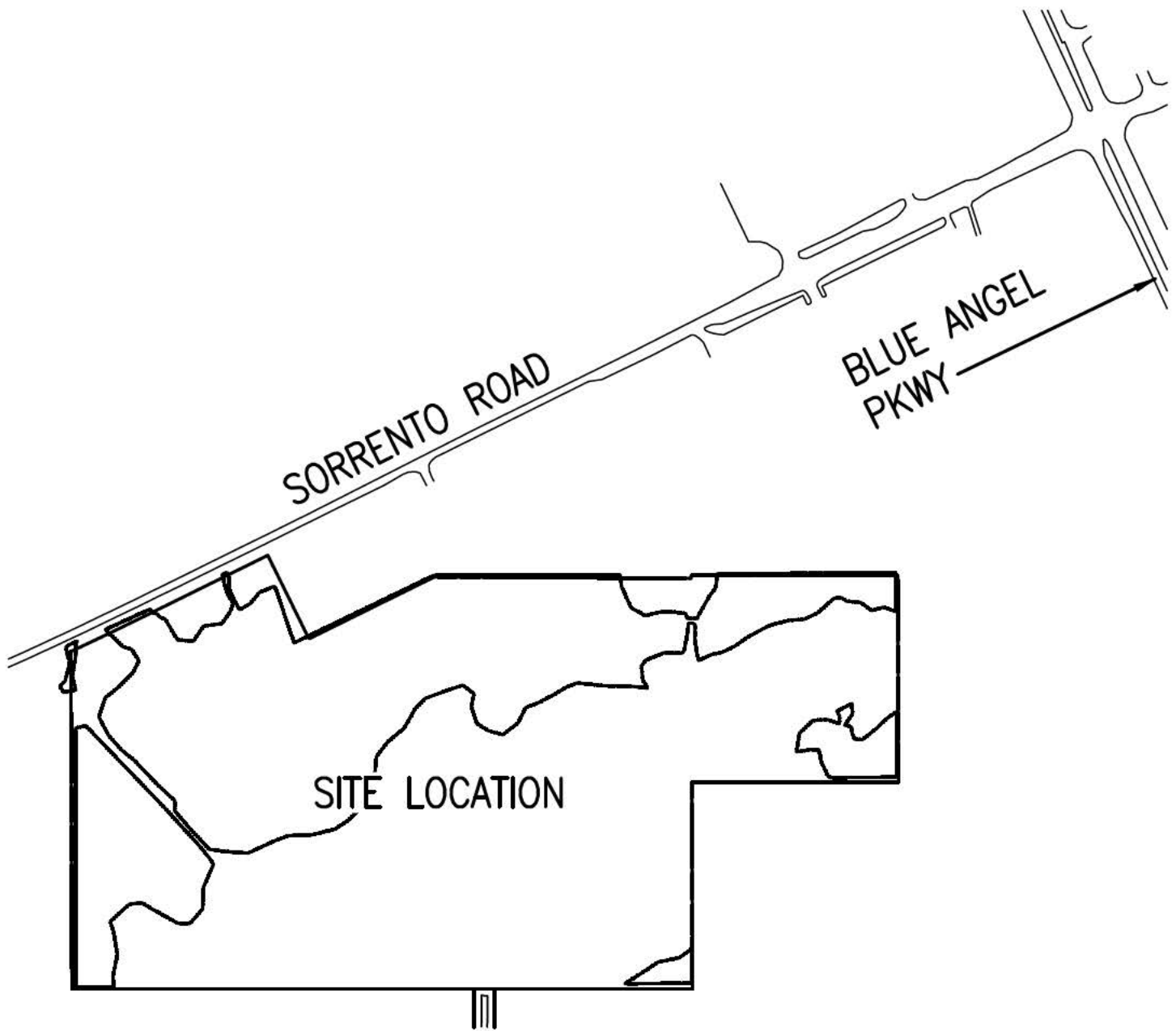

LEGEND

	WETLAND
	PROPOSED ASPHALT
	PROPOSED WETLAND IMPACT
	PROPOSED SURFACE WATER IMPACT

INDEX OF DRAWINGS

1. VICINITY MAP & LEGEND
2. EXISTING SITE
3. PROPOSED OVERALL CONDITIONS
4. PROPOSED SITE
5. PLAN & PROFILE
6. PLAN & PROFILE
7. PROPOSED CONSERVATION EASEMENT



Kenneth Horne & Associates, Inc.
CIVIL ENGINEERS

PO BOX 10669, PENSACOLA, FLORIDA 32524
7201 NORTH 9TH AVENUE, SUITE 6, PENSACOLA, FLORIDA 32504
(850) 471-9005 INFO@KH-A.COM FAX (850) 471-0093

PROJECT NAME: WESTSIDE ELEMENTARY SCHOOL

SORRENTO ROAD PENSACOLA, FL 32514

PROJECT NO: 2018-01

BY: NK/RT DATE: APRIL 2020

SHEET: 1 OF 7

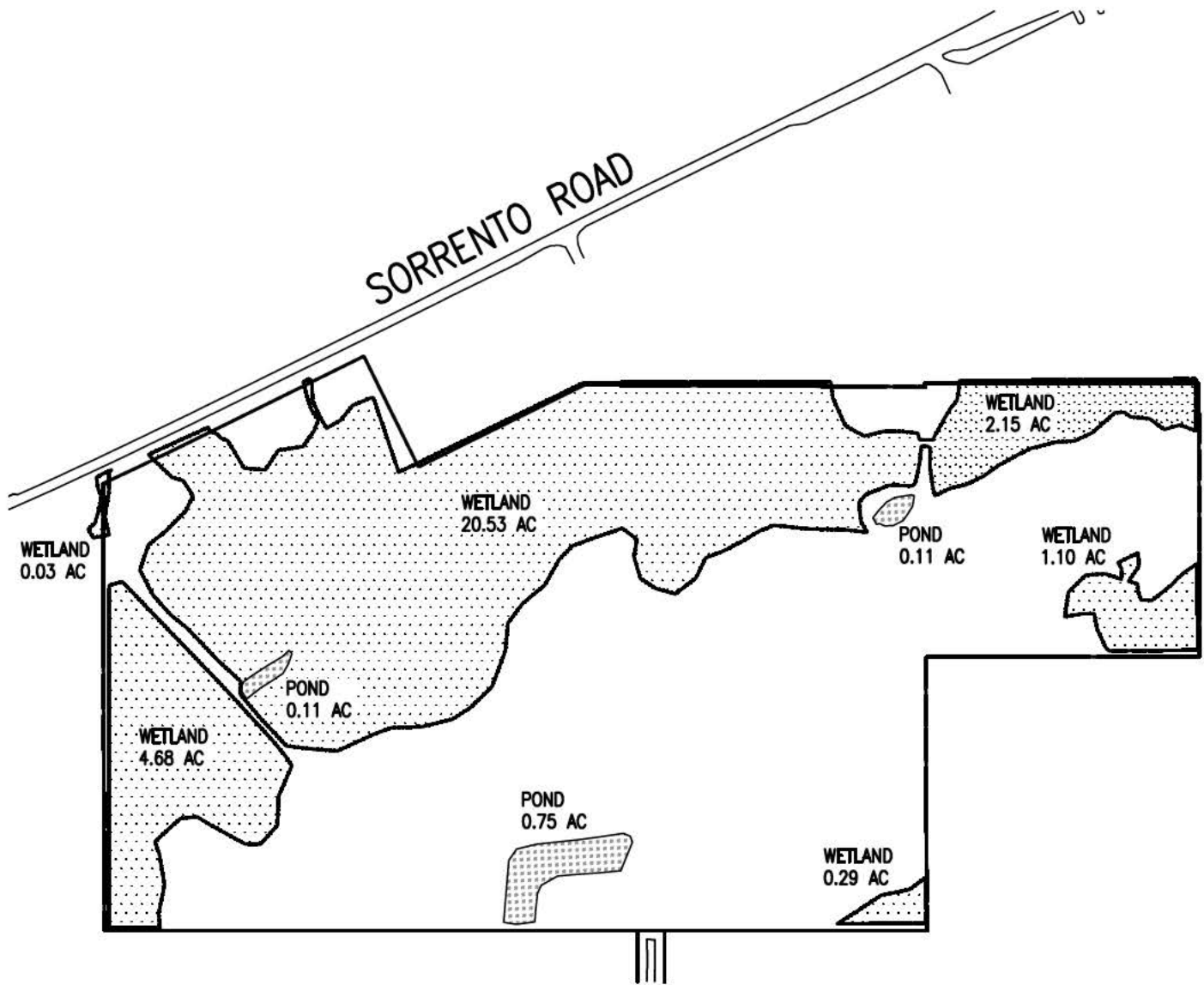

EXISTING SITE

SCALE: 1" = 400'

FOR LEGEND SEE SHT 1 (TYP)

AREAS

OVERALL SITE AREA: 2,961,360 SF / 67.98 ACRES
 WETLAND AREA: 1,253,661 SF / 28.78 ACRES
 SURFACE WATER: 42,177 SF / 0.97 ACRES
 UPLAND AREA: 1,665,522 SF / 38.23 ACRES
 EXISTING Pervious AREA: 2,961,360 SF / 67.98 ACRES
 EXISTING IMPERVIOUS AREA: 0 SF / 0 ACRES



Kenneth Horne & Associates, Inc.
 CIVIL ENGINEERS

PO BOX 10669, PENSACOLA, FLORIDA 32524
 7201 NORTH 9TH AVENUE, SUITE 6, PENSACOLA, FLORIDA 32504
 (850) 471-9005 INFO@KH-A.COM FAX (850) 471-0093

PROJECT NAME: WESTSIDE ELEMENTARY SCHOOL

SORRENTO ROAD PENSACOLA, FL 32514

PROJECT NO: 2018-01

BY: NK/RT DATE: APRIL 2020

SHEET: 2 OF 7

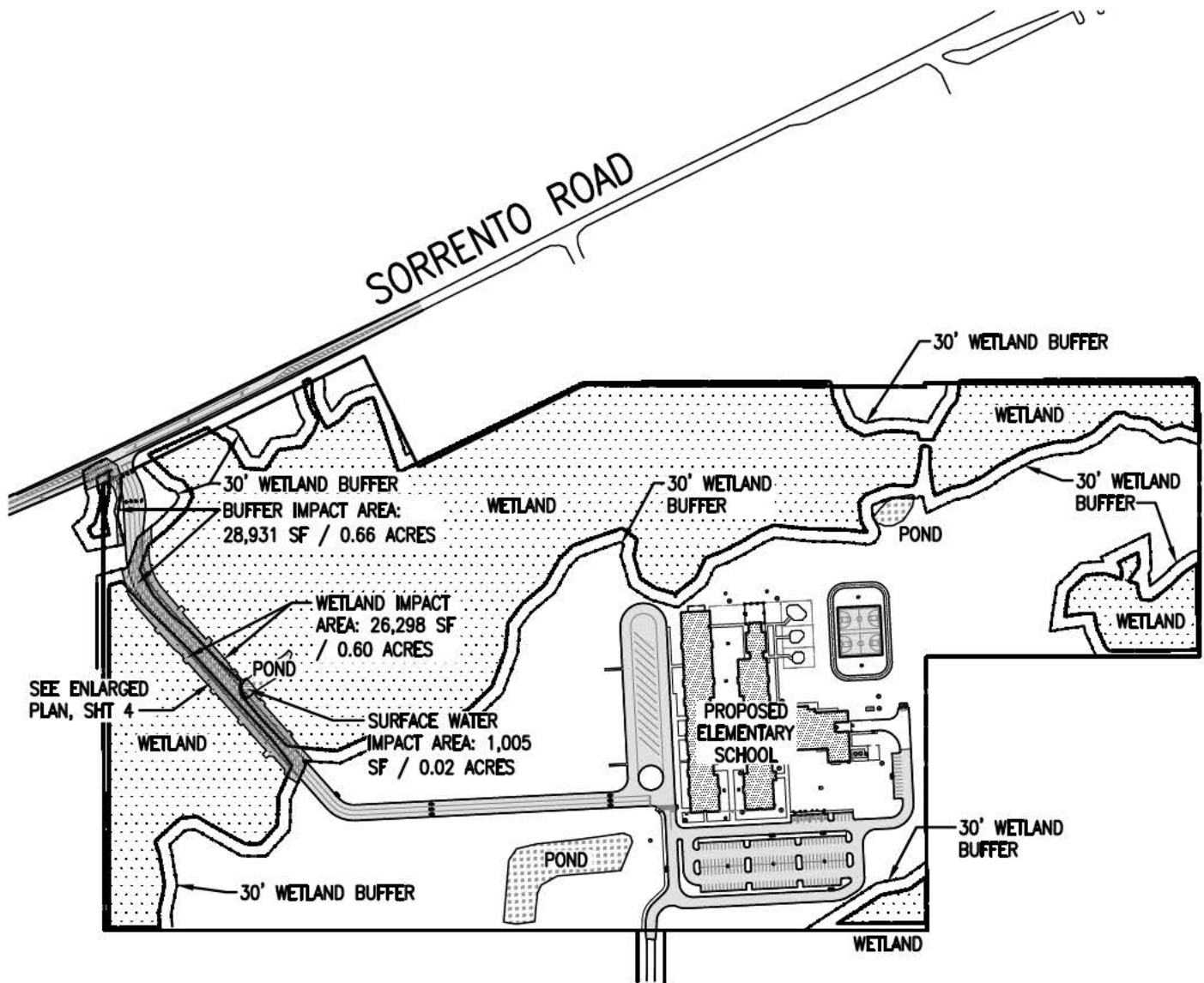

PROPOSED OVERALL CONDITIONS

SCALE: 1" = 400'

FOR LEGEND SEE SHT 1 (TYP)

OVERALL SITE AREA: 2,961,360 SF / 67.98 ACRES
 WETLAND AREA: 1,253,661 SF / 28.78 ACRES
 WETLAND IMPACT AREA: 26,298 SF / 0.60 ACRES
 BUFFER IMPACT AREA: 28,931 SF / 0.66 ACRES
 SURFACE WATER: 42,177 SF / 0.97 ACRES
 SURFACE WATER IMPACT AREA: 1,005 SF / 0.02 ACRES
 UPLAND AREA: 1,665,522 SF / 38.23 ACRES
 PROPOSED IMPERVIOUS AREA: 369,987 SF / 8.49 ACRES
 REMAINING PERVIOUS AREA: 2,591,373 SF / 59.49 ACRES



Kenneth Horne & Associates, Inc.
CIVIL ENGINEERS

PO BOX 10669, PENSACOLA, FLORIDA 32524
 7201 NORTH 9TH AVENUE, SUITE 6, PENSACOLA, FLORIDA 32504
 (850) 471-9005 INFO@KH-A.COM FAX (850) 471-0093

PROJECT NAME: WESTSIDE ELEMENTARY SCHOOL

SORRENTO ROAD PENSACOLA, FL 32514

PROJECT NO: 2018-01

BY: NK/RT DATE: APRIL 2020

SHEET: 3 OF 7

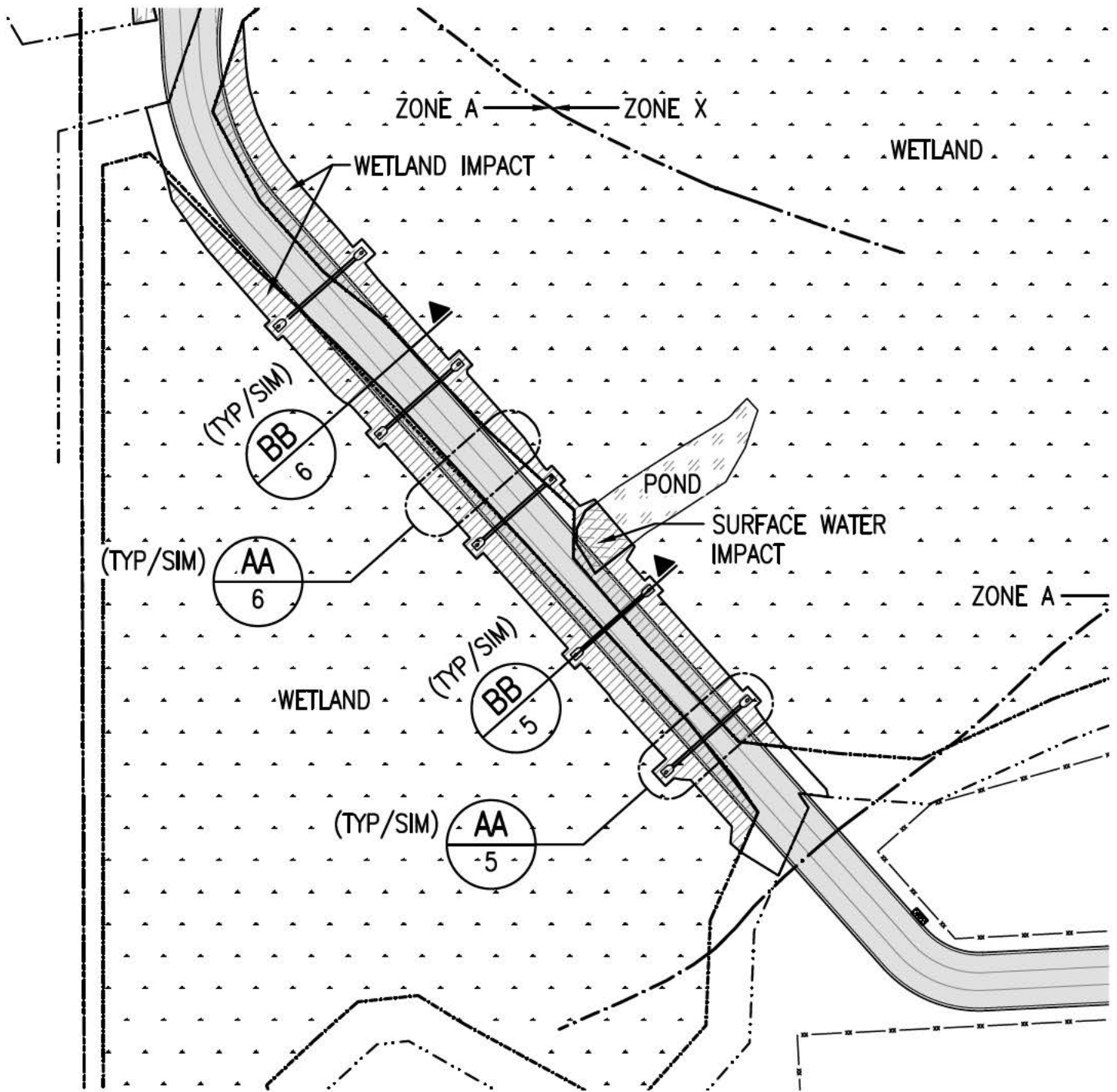

FOR LEGEND SEE SHT 1 (TYP)



PROPOSED SITE

SCALE: 1" = 100'



Kenneth Horne & Associates, Inc.
CIVIL ENGINEERS

PO BOX 10669, PENSACOLA, FLORIDA 32524
7201 NORTH 9TH AVENUE, SUITE 6, PENSACOLA, FLORIDA 32504
(850) 471-9005 INFO@KH-A.COM FAX (850) 471-0093

PROJECT NAME: WESTSIDE ELEMENTARY SCHOOL

SORRENTO ROAD PENSACOLA, FL 32514

PROJECT NO: 2018-01

BY: NK/RT

DATE: APRIL 2020

SHEET: 4

OF

7

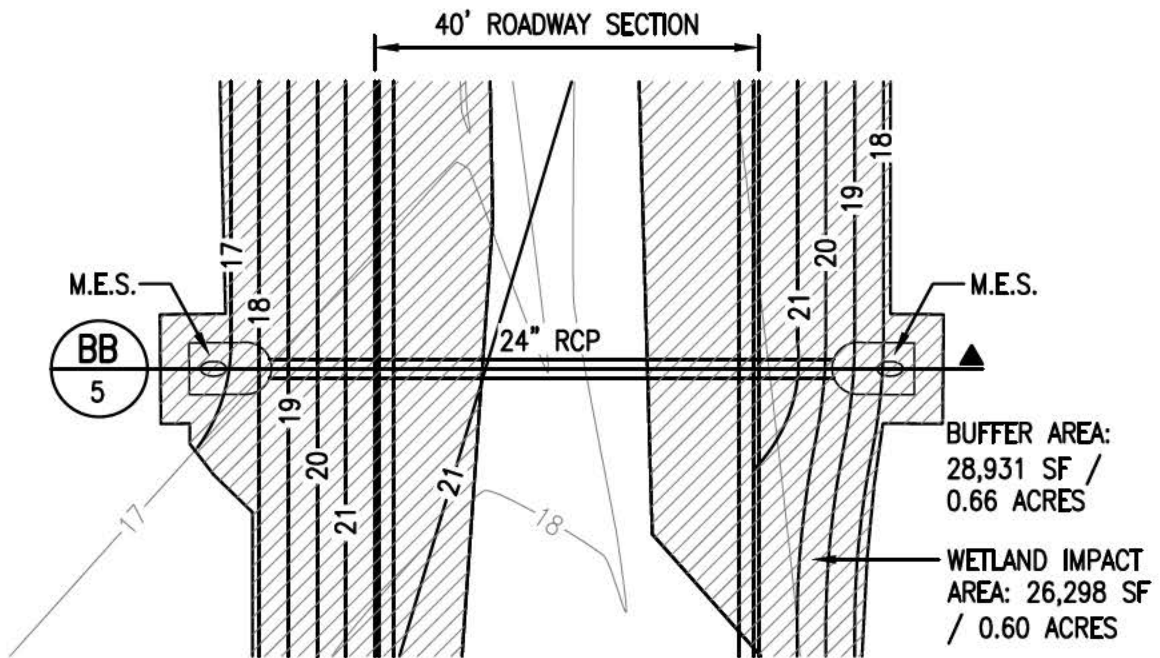

FOR LEGEND SEE SHT 1 (TYP)

A-A TYP UNDERDRAIN PLAN

1" = 20'

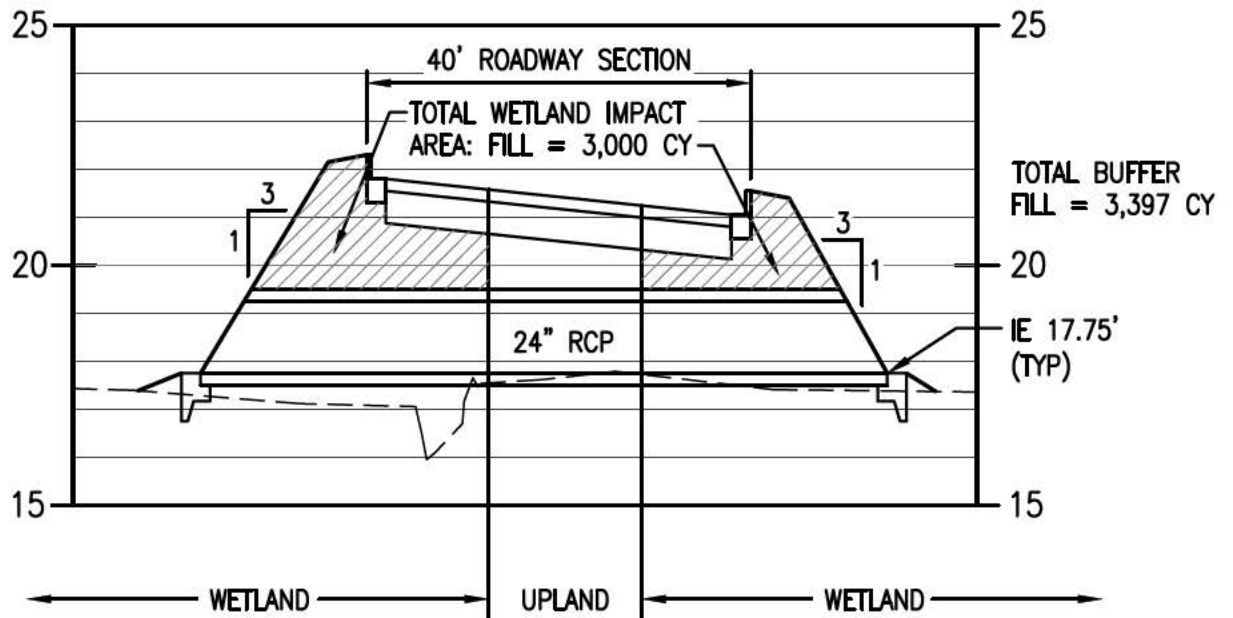

FOR LEGEND SEE SHT 1 (TYP)

B-B TYP UNDERDRAIN PROFILE

1" = 20' H / 1" = 5' V



Kenneth Horne & Associates, Inc.
CIVIL ENGINEERS

PO BOX 10669, PENSACOLA, FLORIDA 32524
7201 NORTH 9TH AVENUE, SUITE 6, PENSACOLA, FLORIDA 32504
(850) 471-9005 INFO@KH-A.COM FAX (850) 471-0093

PROJECT NAME: WESTSIDE ELEMENTARY SCHOOL

SORRENTO ROAD PENSACOLA, FL 32514

PROJECT NO: 2018-01

BY: NK/RT DATE: APRIL 2020

SHEET: 5 OF 7

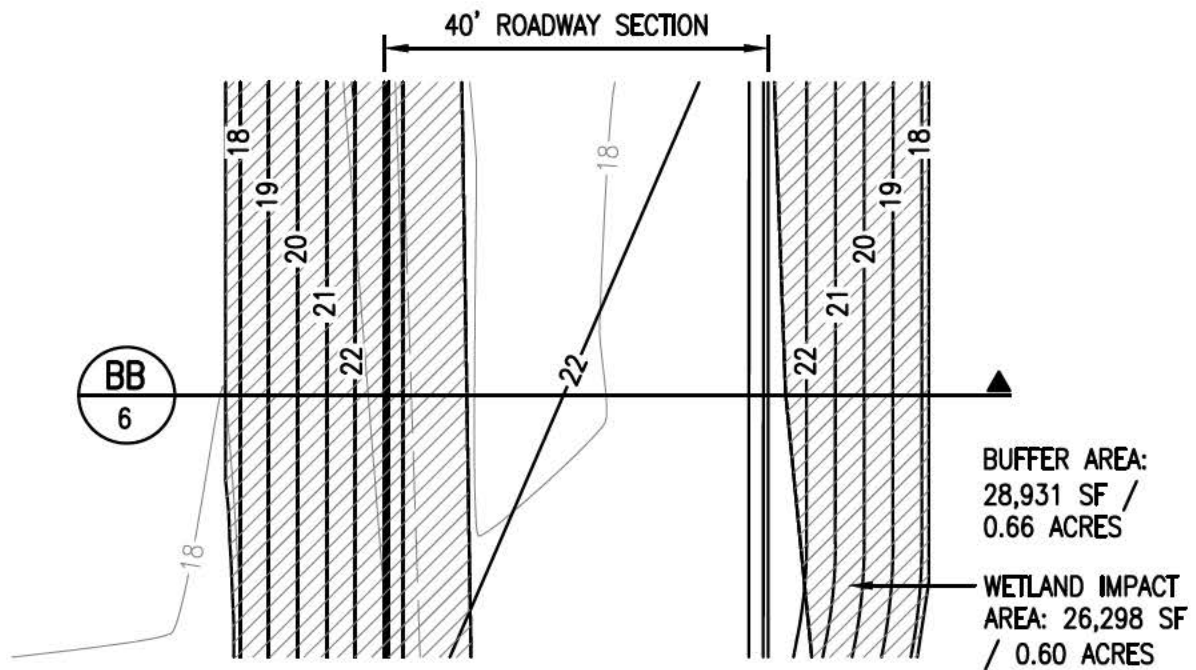

FOR LEGEND SEE SHT 1 (TYP)

A-A TYP ROADWAY PLAN

1" = 20'

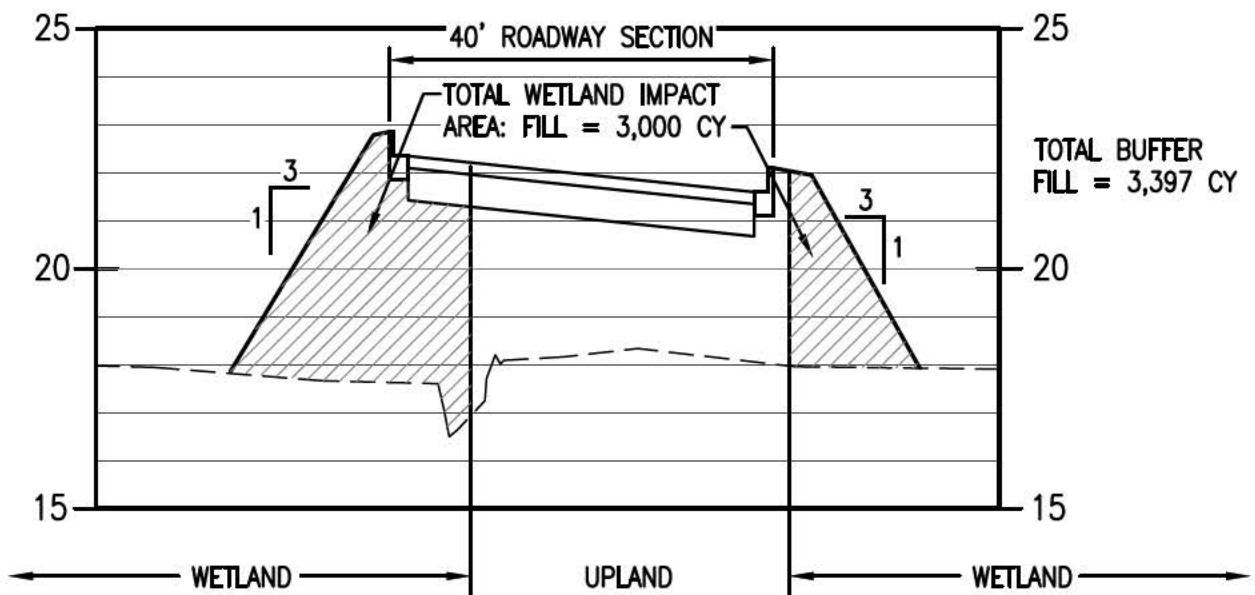

FOR LEGEND SEE SHT 1 (TYP)

B-B TYP ROADWAY PROFILE

1" = 20' H / 1" = 5' V



Kenneth Horne & Associates, Inc.

CIVIL ENGINEERS

PO BOX 10669, PENSACOLA, FLORIDA 32524
7201 NORTH 9TH AVENUE, SUITE 6, PENSACOLA, FLORIDA 32504
(850) 471-9005 INFO@KH-A.COM FAX (850) 471-0093

PROJECT NAME: WESTSIDE ELEMENTARY SCHOOL

SORRENTO ROAD PENSACOLA, FL 32514

PROJECT NO: 2018-01

BY: NK/RT DATE: APRIL 2020

SHEET: 6 OF 7

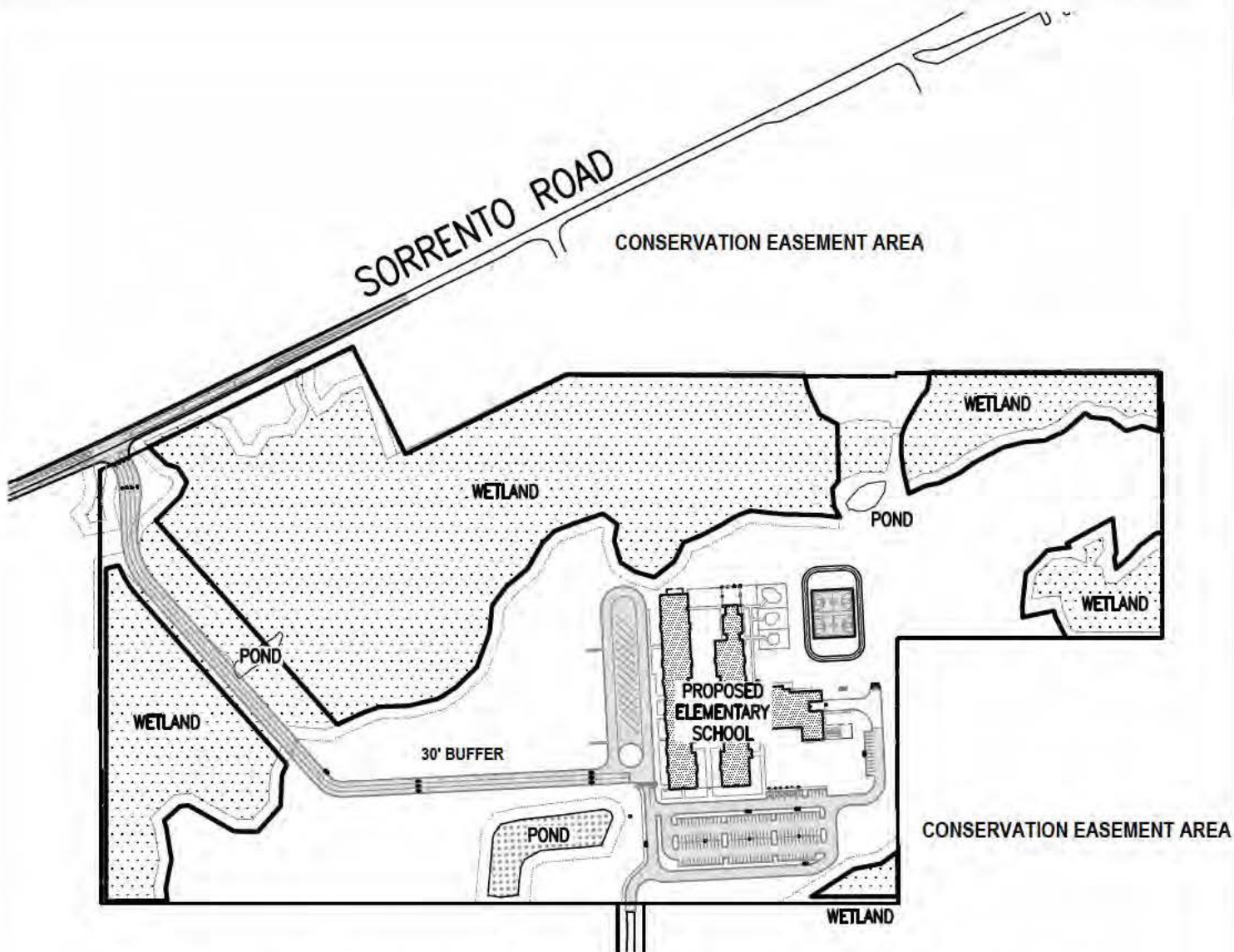

PROPOSED CONSERVATION EASEMENT

SCALE: 1" = 400'

TOTAL WETLANDS IN CONSERVATION EASEMENT:

1,152,011 SF / 26.45 ACRES

TOTAL UPLANDS IN CONSERVATION EASEMENT:

119,023 SF / 2.73 ACRES



Kenneth Horne & Associates, Inc.

CIVIL ENGINEERS

PO BOX 10669, PENSACOLA, FLORIDA 32524

7201 NORTH 9TH AVENUE, SUITE 6, PENSACOLA, FLORIDA 32504
(850) 471-9005 INFO@KH-A.COM FAX (850) 471-0093

PROJECT NAME: WESTSIDE ELEMENTARY SCHOOL

SORRENTO ROAD PENSACOLA, FL 32514

PROJECT NO: 2018-01

BY: NK/RT

DATE: APRIL 2020

SHEET: 7

OF 7