



DEPARTMENT OF THE ARMY
JACKSONVILLE DISTRICT CORPS OF ENGINEERS
1520 ROYAL PALM SQUARE BLVD. SUITE 310
FORT MYERS, FL 33919

REPLY TO

October 8, 2020

Regulatory Division
West Permits Branch
Fort Myers Permits Section

PUBLIC NOTICE

Permit Application No. SAJ-2020-02501 (SP-MLB)

TO WHOM IT MAY CONCERN: The Jacksonville District of the U.S. Army Corps of Engineers (Corps) has received an application for a Department of the Army permit pursuant to Section 10 of the Rivers and Harbors Act of 1899 (33 U.S.C. §403) as described below:

APPLICANT: Barbara Walker
Neapolitan Enterprises, LLC
255 13th Avenue South
Naples, Florida 34102

WATERWAY AND LOCATION: The project would affect waters of the United States associated with Crayton Cove, adjacent to Naples Bay, and the Big Cypress Swamp Watershed (HUC 8: 03090204). The project site is located at the far east end of 8th Street South and west of the Naples City Docking Facility, in Section 10, Township 50 South, Range 25 East, Naples, Collier County, Florida.

Directions to the site are as follows: From I-75 take Exit 101 (County Road 951/Naples/Marco Island); keep right at fork and make a right onto FL-84; merge to the left onto FL-84/Davis Boulevard for 6.5 miles; turn right onto 5th Avenue South/Tamiami Trail and head west for about ½ mile; make a left onto 10th Street South and head south for about 1/8 mile; make a left onto 8th Street South and head south for about ½ mile and the project site will be on your left.

APPROXIMATE CENTRAL COORDINATES: Latitude 26.131872°
Longitude -81.794346°

PROJECT PURPOSE:

Basic: Commercial Marina

Overall: Construct a public docking facility, with access to the Gulf of Mexico, in south Naples, Collier County, Florida.

EXISTING CONDITIONS: The 3.92 acre project area consists of 2.31 acres of waters of the United States (WoUS) and 1.61 acres of uplands. Surrounding the project area is a commercial marina to the east and north, residential development to the west, and a commercial mooring field to the south.

PROPOSED WORK: The proposed project involves the construction of a commercial marina, with 38 wet slips ranging from 30 to 100 feet in length, five (5) of which would be transient to serve commercial facilities, including a restaurant and hotel, to be constructed in the uplands. The project would involve the dredging of 1,536 cubic yards of material from a 31,929 square foot (0.73 acre) area, the filling of 12,603 square feet (0.29 acre) of WoUS, and the installation of docks and decking over 21,678 square feet (0.50 acre) of WoUS. The project would impact 0.013 acre of tidal wetlands (mangroves).

AVOIDANCE AND MINIMIZATION INFORMATION – The applicant has provided the following information in support of efforts to avoid and/or minimize impacts to the aquatic environment:

“Constraints on the construction footprint are of logistical, economic, and regulatory in nature which are dictating the final upland design. The site plan will take all of those factors into consideration, but in order to achieve the project purpose while making it economically viable, impacts are unavoidable given constraints outlined above. The applicant has provided appropriate mitigation for those impacts that are unavoidable.”

COMPENSATORY MITIGATION – The applicant has offered the following compensatory mitigation plan to offset unavoidable functional loss to the aquatic environment:

Mitigation would consist of purchasing 0.16 saltwater forested federal mitigation credit from the Little Pine Island Mitigation Bank for unavoidable impacts to wetlands (mangroves).

CULTURAL RESOURCES:

The Corps is not aware of any known historic properties within the permit area. By copy of this public notice, the Corps is providing information for review. Our final determination relative to historic resource impacts is subject to review by and coordination with the State Historic Preservation Officer and those federally recognized tribes with concerns in Florida and the Permit Area.

ENDANGERED SPECIES:

The Corps has determined that the proposed project **may affect** the West Indian manatee (*Trichechus manatus*) since the proposed project would restrict or act as a barrier to manatees. The Corps requested U.S. Fish and Wildlife concurrence with this determination, via email on October 7, 2020, pursuant to Section 7 of the Endangered Species Act.

The Corps has determined that the proposed project **may affect, but is not likely to adversely affect** the Smalltooth sawfish (*Pristis pectinate*) and swimming sea turtles. The Corps requested National Marine Fisheries Service concurrence with this

determination via email on October 7, 2020, pursuant to Section 7 of the Endangered Species Act

The Corps has determined the proposal would have **no effect** on the American Crocodile (*Crocodylus acutus*), Florida Bonneted Bat (*Eumops floridanus*), Florida scrub jay (*Aphelocoma coerulescens*), Piping Plover (*Charadrius melodus*), Eastern Black Rail (*Laterallus jamaicensis jamaicensis*), and/or their designated critical habitat. No further consultation with the Service is required for these species.

ESSENTIAL FISH HABITAT (EFH): This notice initiates consultation with the National Marine Fisheries Service on EFH as required by the Magnuson-Stevens Fishery Conservation and Management Act 1996. The proposal would impact approximately 0.013 acre of Red Mangroves (*Rhizophora mangle*) utilized by various life stages of fish. Our initial determination is that the proposed action would not have a substantial adverse impact on EFH or Federally managed fisheries in the Gulf of Mexico. Our final determination relative to project impacts and the need for mitigation measures is subject to review by and coordination with the National Marine Fisheries Service.

NOTE: This public notice is being issued based on information furnished by the applicant. This information has not been verified or evaluated to ensure compliance with laws and regulation governing the regulatory program. The jurisdictional line has not been verified by Corps personnel.

AUTHORIZATION FROM OTHER AGENCIES: Water Quality Certification may be required from the Florida Department of Environmental Protection and/or one of the state Water Management Districts.

COMMENTS regarding the potential authorization of the work proposed should be submitted in writing to the attention of the District Engineer through the Fort Myers Permits Section, 1520 Royal Palm Square Blvd. Suite 310, Fort Myers, FL 33919 within 30 days from the date of this notice.

The decision whether to issue or deny this permit application will be based on the information received from this public notice and the evaluation of the probable impact to the associated wetlands. This is based on an analysis of the applicant's avoidance and minimization efforts for the project, as well as the compensatory mitigation proposed.

QUESTIONS concerning this application should be directed to the project manager, Michelle L. Bartley, in writing at the Fort Myers Permits Section, 1520 Royal Palm Square Blvd. Suite 310, Fort Myers, FL 33919; by electronic mail at Michelle.L.Bartley@usace.army.mil; or, by telephone at (239)334-1975 ext. 0006.

IMPACT ON NATURAL RESOURCES: Coordination with U.S. Fish and Wildlife Service, Environmental Protection Agency (EPA), the National Marine Fisheries Services, and other Federal, State, and local agencies, environmental groups, and concerned citizens generally yields pertinent environmental information that is

instrumental in determining the impact the proposed action will have on the natural resources of the area.

EVALUATION: The decision whether to issue a permit will be based on an evaluation of the probable impact including cumulative impacts of the proposed activity on the public interest. That decision will reflect the national concern for both protection and utilization of important resources. The benefits, which reasonably may be expected to accrue from the proposal, must be balanced against its reasonably foreseeable detriments. All factors which may be relevant to the proposal will be considered including cumulative impacts thereof; among these are conservation, economics, aesthetics, general environmental concerns, wetlands, historical properties, fish and wildlife values, flood hazards, floodplain values, land use, navigation, shoreline erosion and accretion, recreation, water supply and conservation, water quality, energy needs, safety, food, and fiber production, mineral needs, considerations of property ownership, and in general, the needs and welfare of the people. Evaluation of the impact of the activity on the public interest will also include application of the guidelines promulgated by the Administrator, EPA, under authority of Section 404(b) of the Clean Water Act or the criteria established under authority of Section 102(a) of the Marine Protection Research and Sanctuaries Act of 1972. A permit will be granted unless its issuance is found to be contrary to the public interest.

The US Army Corps of Engineers (Corps) is soliciting comments from the public; Federal, State, and local agencies and officials; Indian Tribes; and other Interested parties in order to consider and evaluate the impacts of this proposed activity. Any comments received will be considered by the Corps to determine whether to issue, modify, condition, or deny a permit for this proposal. To make this determination, comments are used to assess impacts to endangered species, historic properties, water quality, general environmental effects, and the other public interest factors listed above. Comments are also used to determine the need for a public hearing and to determine the overall public interest of the proposed activity.

COASTAL ZONE MANAGEMENT CONSISTENCY: In Florida, the State approval constitutes compliance with the approved Coastal Zone Management Plan. In Puerto Rico, a Coastal Zone Management Consistency Concurrence is required from the Puerto Rico Planning Board. In the Virgin Islands, the Department of Planning and Natural Resources permit constitutes compliance with the Coastal Zone Management Plan.

REQUEST FOR PUBLIC HEARING: Any person may request a public hearing. The request must be submitted in writing to the District Engineer within the designated comment period of the notice and must state the specific reasons for requesting the public hearing.

STATE OF FLORIDA

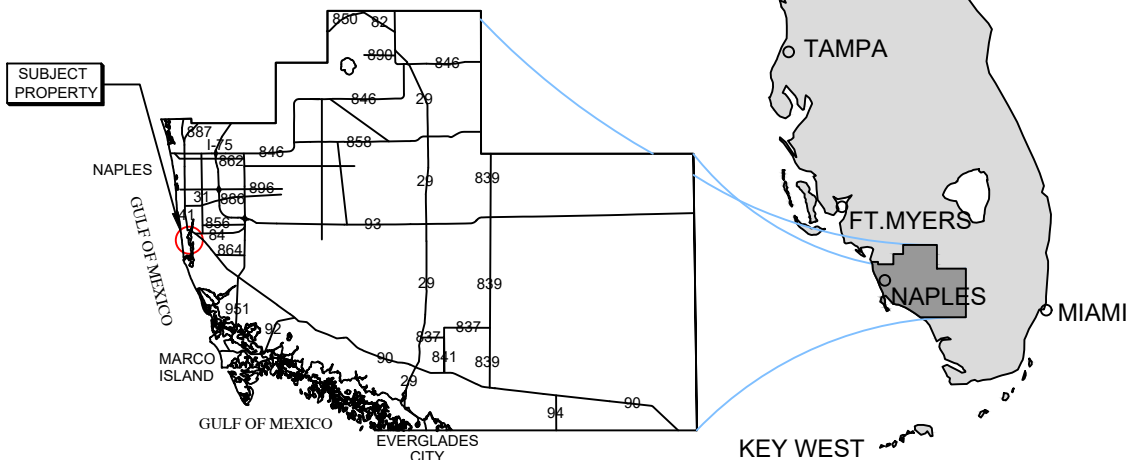
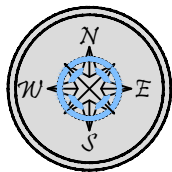

COLLIER COUNTY

SITE ADDRESS:

<> 860 12TH AVE S
NAPLES, FL 34102

<> LATITUDE: N 26.13183
<> LONGITUDE: W 81.794029

NOTES:

AND ARE NOT A BASIS FOR PERMITTING PURPOSES ONLY

SUBJECT
PROPERTY

SUBJECT
PROPERTY

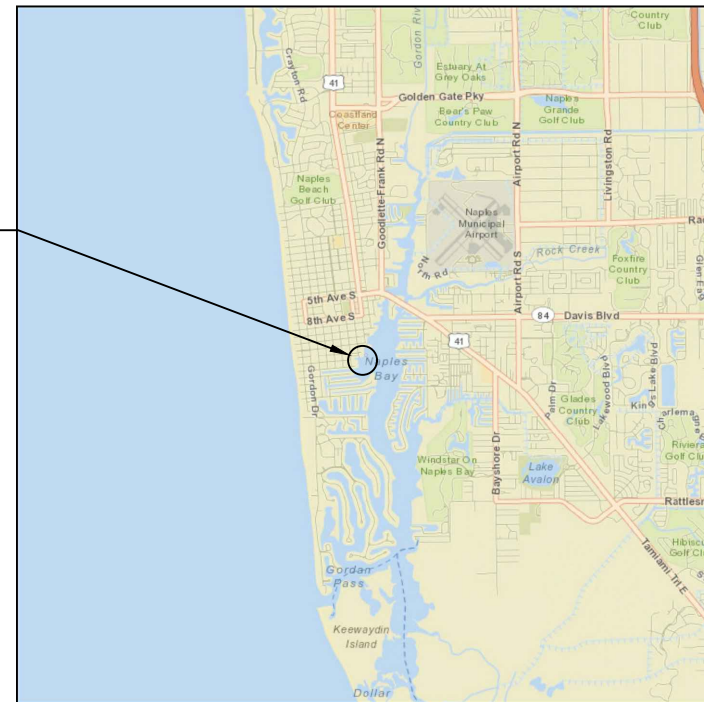

VICINITY MAP



COUNTY AERIAL



Turrell, Hall & Associates, Inc.
Marine & Environmental Consulting
3584 Exchange Ave. Naples, FL 34104-3732

Email: tuna@thanaples.com Phone: (239) 643-0166 Fax: (239) 643-6632

CRAYTON COVE MARINA LOCATION MAP

DESIGNED:	JR	REV#	REV BY	DATE	CHK BY	CHANGES
DRAWN BY:	RMJ	1.	-	-	-	-
CREATED:	07-08-20	2.	-	-	-	-
JOB NO.:	0566.1	3.	-	-	-	-
SHEET NO.:	01 OF 14	4.	-	-	-	-
		5.	-	-	-	-
SECTION-9		TOWNSHIP- 50		RANGE- 25		

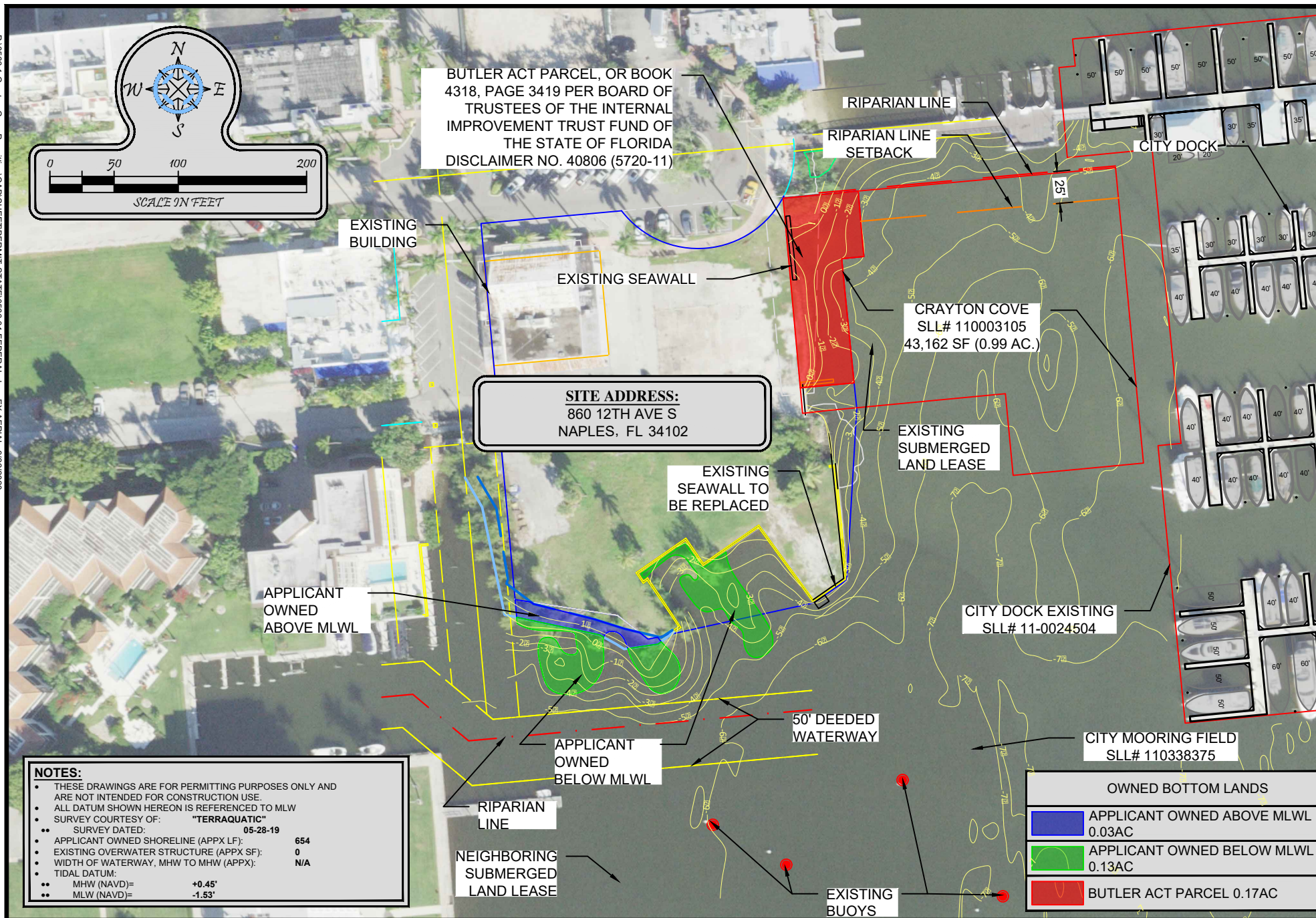

Turrell, Hall & Associates, Inc.
Marine & Environmental Consulting

3584 Exchange Ave. Naples, FL 34104-3732

Email: tuna@thanaples.com Phone: (239) 643-0166 Fax: (239) 643-6632

CRAYTON COVE MARINA **EXISTING AERIAL**

THESE DRAWINGS ARE FOR PERMITTING PURPOSES ONLY AND ARE NOT INTENDED FOR CONSTRUCTION USE.

DESIGNED:	JR	REV#	REV BY	DATE	CHK BY	CHANGED
DRAWN BY:	RMJ	1.	-	-	-	-
CREATED:	07-08-20	2.	-	-	-	-
JOB NO.:	0566.1	3.	-	-	-	-
SHEET NO.:	02 OF 14	4.	-	-	-	-
		5.	-	-	-	-

SECTION-9 TOWNSHIP- 50S RANGE- 25E



NOTES:

- THESE DRAWINGS ARE FOR PERMITTING PURPOSES ONLY AND ARE NOT INTENDED FOR CONSTRUCTION USE.
- ALL DATUM SHOWN HEREON IS REFERENCED TO MLW
- SURVEY COURTESY OF: "TERRAQUATIC"
- SURVEY DATED: 05-28-19
- APPLICANT OWNED SHORELINE (APPX LF): 654'
- EXISTING OVERWATER STRUCTURE (APPX SF): 0'
- WIDTH OF WATERWAY, MHW TO MHW (APPX): N/A'
- TIDAL DATUM:
- MHW (NAVD)= +0.45'
- MLW (NAVD)= -1.53'
- PROPOSED OVERWATER STRUCTURE (FLOAT) (APPX SF): 13,900'
- PROPOSED OVERWATER STRUCTURE (FIXED) (APPX SF): 7,778'
- TOTAL OVERWATER STRUCTURE (APPX SF): 21,678'
- TOTAL PROTRUSION FROM MHWL: N/A'



Turrell, Hall & Associates, Inc.
Marine & Environmental Consulting
3584 Exchange Ave. Naples, FL 34104-3732

Email: tuna@thanaples.com Phone: (239) 643-0166 Fax: (239) 643-6632

CRAYTON COVE MARINA **SITE PLAN**

DESIGNED:	JR	REV#	REV BY	DATE	CHK BY	CHANGED:
DRAWN BY:	RMJ	1.	-	-	-	-
CREATED:	07-08-20	2.	-	-	-	-
JOB NO.:	0566.1	3.	-	-	-	-
SHEET NO.:	04 OF 14	4.	-	-	-	-
		5.	-	-	-	-
SECTION-9		TOWNSHIP- 50		RANGE- 25		

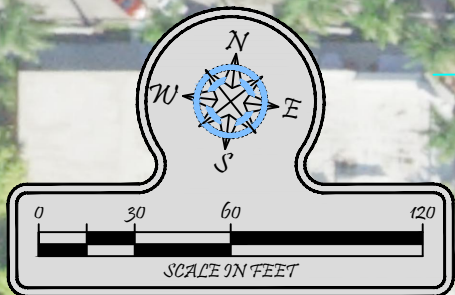

NOTES:

- THESE DRAWINGS ARE FOR PERMITTING PURPOSES ONLY AND ARE NOT INTENDED FOR CONSTRUCTION USE.
- ALL DATUM SHOWN HEREON IS REFERENCED TO MLW
- SURVEY COURTESY OF: "TERRAQUATIC"
- SURVEY DATED: 05-28-19
- APPLICANT OWNED SHORELINE (APPX LF): 654
- EXISTING OVERWATER STRUCTURE (APPX SF): 0
- WIDTH OF WATERWAY, MHW TO MHW (APPX): N/A
- TIDAL DATUM:
- MHW (NAVD)= +0.45'
- MLW (NAVD)= -1.53'

SEAWALLS 1,278 SF

	EXISTING SEAWALL	403 LF
	PROPOSED SEAWALL	852 LF



Turrell, Hall & Associates, Inc.
Marine & Environmental Consulting
3584 Exchange Ave. Naples, FL 34104-3732

Email: tuna@thanaples.com Phone: (239) 643-0166 Fax: (239) 643-6632

CRAYTON COVE MARINA PROPOSED SEAWALL

THESE DRAWINGS ARE FOR PERMITTING PURPOSES ONLY AND ARE NOT INTENDED FOR CONSTRUCTION USE.

DESIGNED:	JR	REV#	REV BY	DATE	CHK BY	CHANGED
DRAWN BY:	RMJ	1.	-	-	-	-
CREATED:	07-08-20	2.	-	-	-	-
JOB NO.:	0566.1	3.	-	-	-	-
SHEET NO.:	05 OF 14	4.	-	-	-	-
		5.	-	-	-	-
SECTION-9		TOWNSHIP- 50 S		RANGE- 25 E		

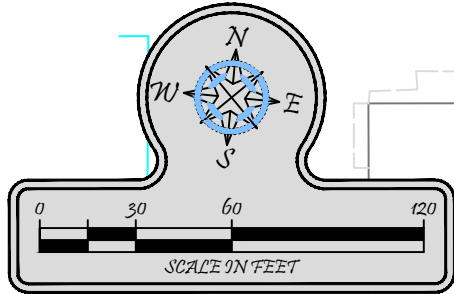

NOTES:

- THESE DRAWINGS ARE FOR PERMITTING PURPOSES ONLY AND ARE NOT INTENDED FOR CONSTRUCTION USE.
- ALL DATUM SHOWN HEREON IS REFERENCED TO MLW
- SURVEY COURTESY OF: "TERRAQUATIC"
- SURVEY DATED: 05-28-19
- APPLICANT OWNED SHORELINE (APPX LF): 654
- EXISTING OVERWATER STRUCTURE (APPX SF): 0
- WIDTH OF WATERWAY, MHW TO MHW (APPX): N/A
- TIDAL DATUM:
- MHW (NAVD)= +0.45'
- MLW (NAVD)= -1.53'
- PROPOSED OVERWATER STRUCTURE (FLOAT) (APPX SF): 13,990
- PROPOSED OVERWATER STRUCTURE (FIXED) (APPX SF): 7,778
- TOTAL OVERWATER STRUCTURE (APPX SF): 21,678
- TOTAL PROTRUSION FROM MHWL: N/A

RIPRAP OVER PRIVATELY OWNED BOTTOM	0.03 AC
RIPRAP OVER STATE OWNED BOTTOM	0.06 AC
RIPRAP ABOVE MEAN HIGH WATER	0.001 AC

PROPOSED GANGWAYS
BUTLER ACT AREA TO FILL

FLOATING DOCK

PROPOSED RIPRAP BELOW MHWL

FLOATING DOCKS

PROPOSED RIPRAP BELOW MHWL

PROPOSED GANGWAY

PROPOSED RIPRAP ABOVE MHWL

FLOATING DOCK

RIPRAP (361 LF/ 3,920 SF)

	RIPRAP BELOW MHWL	311 CY
	RIPRAP ABOVE MHWL	61 CY

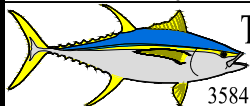

Turrell, Hall & Associates, Inc.
Marine & Environmental Consulting
3584 Exchange Ave. Naples, FL 34104-3732
Email: tuna@thanaples.com Phone: (239) 643-0166 Fax: (239) 643-6632

CRAYTON COVE MARINA RIPRAP PLAN

DESIGNED: JR	1.	-	-	-	-
DRAWN BY: RMJ	2.	-	-	-	-
CREATED: 07-08-20	3.	-	-	-	-
JOB NO.: 0566.1	4.	-	-	-	-
SHEET NO.: 06 OF 14	5.	-	-	-	-
SECTION-9	TOWNSHIP- 50	RANGE- 25			

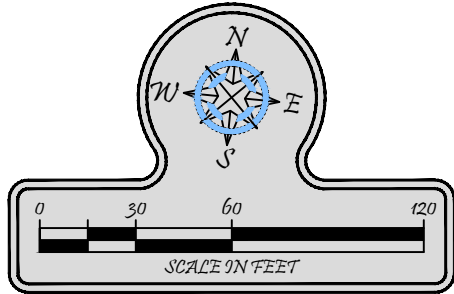

NOTES:

- THESE DRAWINGS ARE FOR PERMITTING PURPOSES ONLY AND ARE NOT INTENDED FOR CONSTRUCTION USE.
- ALL DATUM SHOWN HEREON IS REFERENCED TO MLW
- SURVEY COURTESY OF: "TERRAQUATIC"
- SURVEY DATED: 05-28-19
- APPLICANT OWNED SHORELINE (APPX LF): 654
- EXISTING OVERWATER STRUCTURE (APPX SF): 0
- WIDTH OF WATERWAY, MHW TO MHW (APPX): N/A
- TIDAL DATUM:
- MHW (NAVD)= +0.45'
- MLW (NAVD)= -1.53'
- PROPOSED OVERWATER STRUCTURE (FLOAT) (APPX SF): 13,990
- PROPOSED OVERWATER STRUCTURE (FIXED) (APPX SF): 7,778
- TOTAL OVERWATER STRUCTURE (APPX SF): 21,678
- TOTAL PROTRUSION FROM MHWL: N/A

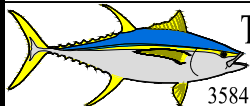
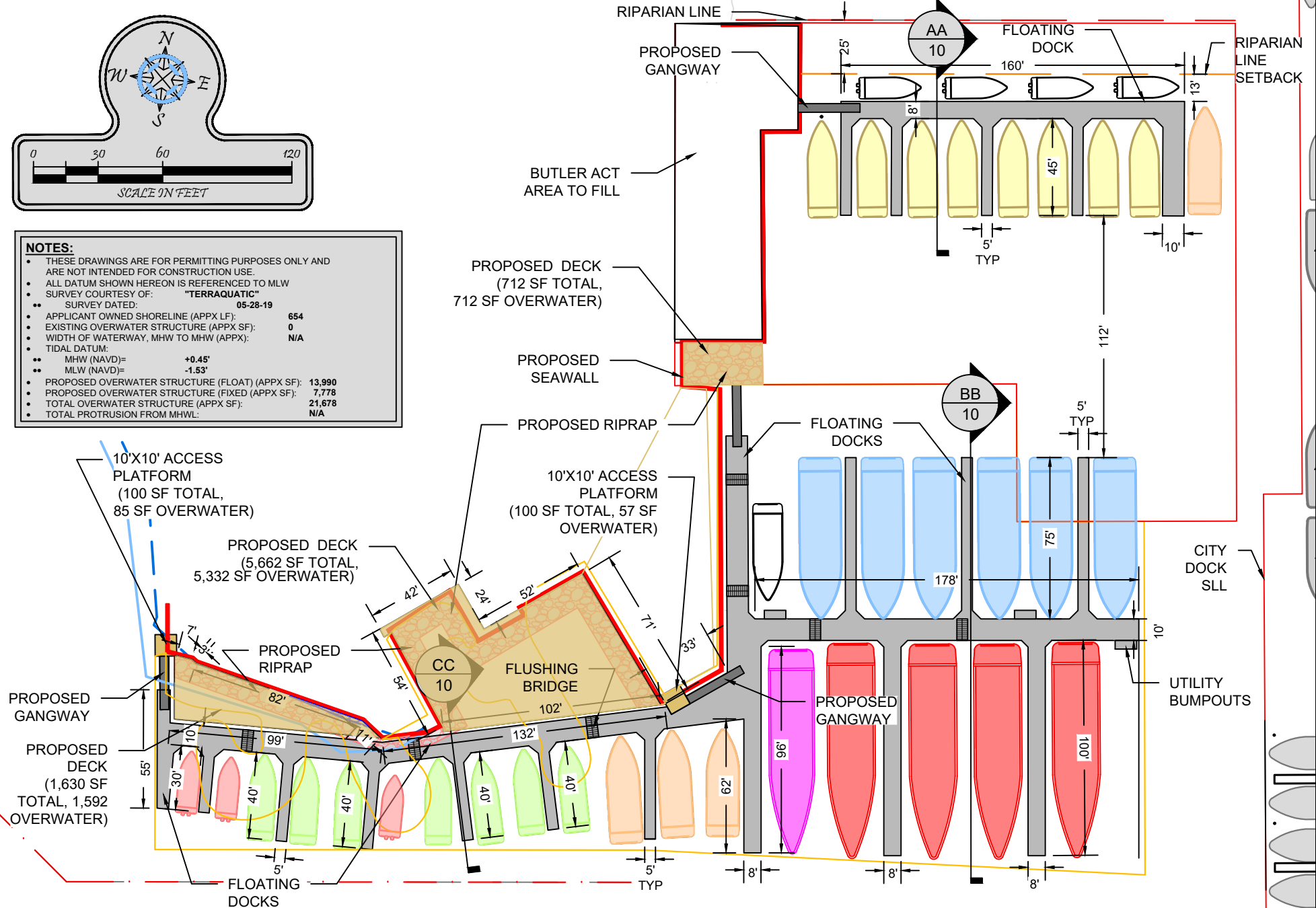

Turrell, Hall & Associates, Inc.
Marine & Environmental Consulting

3584 Exchange Ave. Naples, FL 34104-3732

Email: tuna@thanaples.com Phone: (239) 643-0166 Fax: (239) 643-6632

CRAYTON COVE MARINA

PROPOSED DOCKS WITH DIMENSIONS

DESIGNED:	JR	REV#	REV BY	DATE	CHK BY	CHANGED
DRAWN BY:	RMJ	1.	-	-	-	-
CREATED:	07-08-20	2.	-	-	-	-
JOB NO.:	0566.1	3.	-	-	-	-
SHEET NO.:	07 OF 14	4.	-	-	-	-
		5.	-	-	-	-
SECTION-9		TOWNSHIP- 50		RANGE- 25		

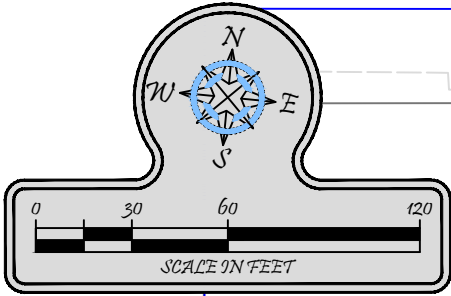

LENGTH (LOA)	BEAM (MAX)	SLIPS
30	14	3
40	17	7
45	18	8
50	20	4
75	23	6
95	29	1
100	30	4
TOTAL		33
TRANSIENT SLIPS		5

NOTES:

- THESE DRAWINGS ARE FOR PERMITTING PURPOSES ONLY AND ARE NOT INTENDED FOR CONSTRUCTION USE.
- ALL DATUM SHOWN HEREON IS REFERENCED TO MLW
- SURVEY COURTESY OF: "TERRAQUATIC"
- SURVEY DATED: 05-28-19
- APPLICANT OWNED SHORELINE (APPX LF): 654
- EXISTING OVERWATER STRUCTURE (APPX SF): 0
- WIDTH OF WATERWAY, MHW TO MHW (APPX): N/A
- TIDAL DATUM:
 - MHW (NAVD)= +0.45'
 - MLW (NAVD)= -1.53'
- PROPOSED OVERWATER STRUCTURE (FLOAT) (APPX SF): 13,990
- PROPOSED OVERWATER STRUCTURE (FIXED) (APPX SF): 7,778
- TOTAL OVERWATER STRUCTURE (APPX SF): 21,678
- TOTAL PROTRUSION FROM MHWL: N/A

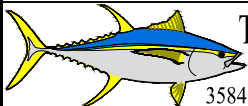
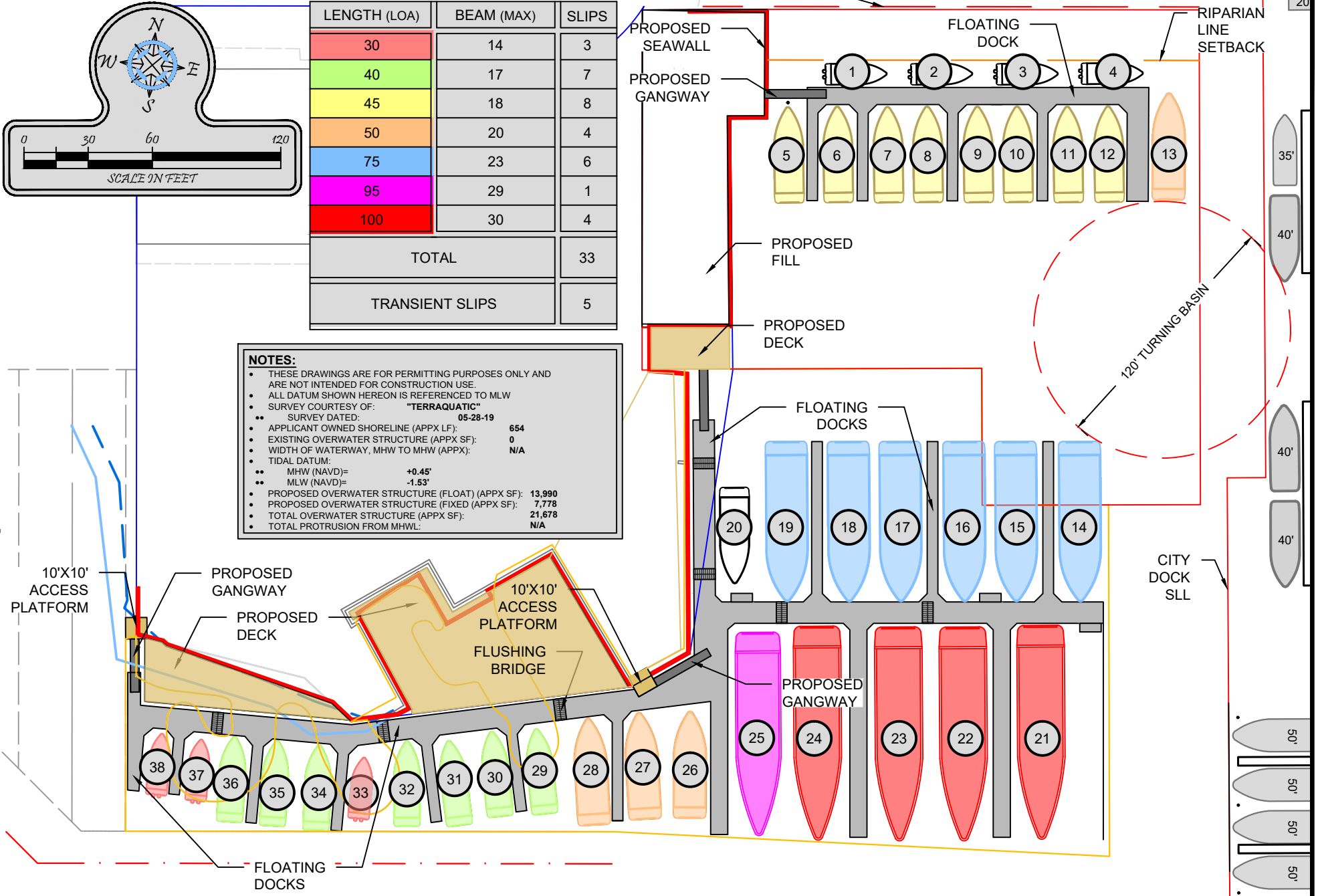

Turrell, Hall & Associates, Inc.
Marine & Environmental Consulting

3584 Exchange Ave. Naples, FL 34104-3732

Email: tuna@thanaples.com Phone: (239) 643-0166 Fax: (239) 643-6632

CRAYTON COVE MARINA PROPOSED DOCK MATRIX

DESIGNED:	JR	REV#	REV BY	DATE	CHK BY	CHANGED
DRAWN BY:	RMJ	1.	-	-	-	-
CREATED:	07-08-20	2.	-	-	-	-
JOB NO.:	0566.1	3.	-	-	-	-
SHEET NO.:	08 OF 14	4.	-	-	-	-
		5.	-	-	-	-
SECTION-9		TOWNSHIP- 50		RANGE- 25		



NOTES:

- THESE DRAWINGS ARE FOR PERMITTING PURPOSES ONLY AND ARE NOT INTENDED FOR CONSTRUCTION USE.
- ALL DATUM SHOWN HEREON IS REFERENCED TO MLW
- SURVEY COURTESY OF: "TERRAQUATIC"
- SURVEY DATED: 05-28-19
- APPLICANT OWNED SHORELINE (APPX LF): 654
- EXISTING OVERWATER STRUCTURE (APPX SF): 0
- WIDTH OF WATERWAY, MHW TO MHW (APPX): N/A
- TIDAL DATUM:
- MHW (NAVD)= +0.45'
- MLW (NAVD)= -1.53'
- PROPOSED OVERWATER STRUCTURE (FLOAT) (APPX SF): 13,990
- PROPOSED OVERWATER STRUCTURE (FIXED) (APPX SF): 7,778
- TOTAL OVERWATER STRUCTURE (APPX SF): 21,678
- TOTAL PROTRUSION FROM MHWL: N/A

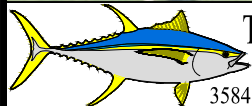

Turrell, Hall & Associates, Inc.
Marine & Environmental Consulting

3584 Exchange Ave. Naples, FL 34104-3732

Email: tuna@thanaples.com Phone: (239) 643-0166 Fax: (239) 643-6632

CRAYTON COVE MARINA

PROPOSED DOCKS WITH BATHYMETRY

DESIGNED:	JR	REV#	REV BY	DATE	CHK BY	CHANGED
DRAWN BY:	RMJ	1.	-	-	-	-
CREATED:	07-08-20	2.	-	-	-	-
JOB NO.:	0566.1	3.	-	-	-	-
SHEET NO.:	09 OF 14	4.	-	-	-	-
		5.	-	-	-	-
SECTION-9		TOWNSHIP- 50		RANGE- 25		

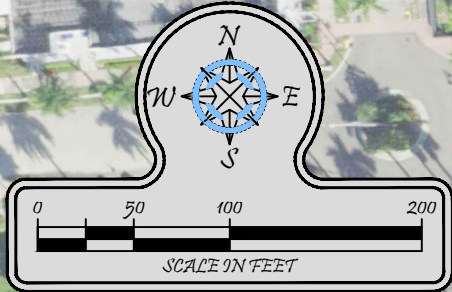

NOTES:

- THESE DRAWINGS ARE FOR PERMITTING PURPOSES ONLY AND ARE NOT INTENDED FOR CONSTRUCTION USE.
- ALL DATUM SHOWN HEREON IS REFERENCED TO MLW
- SURVEY COURTESY OF: "TERRAQUATIC"
- SURVEY DATED: 05-28-19
- APPLICANT OWNED SHORELINE (APPX LF): 654
- EXISTING OVERWATER STRUCTURE (APPX SF): 0
- WIDTH OF WATERWAY, MHW TO MHW (APPX): N/A
- TIDAL DATUM:
 - MHW (NAVD)= +0.45'
 - MLW (NAVD)= -1.53'
- PROPOSED OVERWATER STRUCTURE (FLOAT) (APPX SF): 13,990
- PROPOSED OVERWATER STRUCTURE (FIXED) (APPX SF): 7,778
- TOTAL OVERWATER STRUCTURE (APPX SF): 21,678
- TOTAL PROTRUSION FROM MHWL: N/A

FILL TO 4.8'
(NAVD 88)

50'X50' SPOIL
CONTAINMENT
AREA

FILL TO 4.8'
(NAVD 88)

DREDGE
TO -5 MLW

EXISTING
SLL

CITY DOCK
EXISTING
SUBMERGED
LAND LEASE

DREDGE
TO -5 MLW

DREDGE
TO -7 MLW

PROPOSED
SLL
EXPANSION

50' DEEDED
WATERWAY

PRIVATELY
OWNED
DREDGE
TO -5 MLW

NEIGHBORING
SUBMERGED
LAND LEASE

SOVEREIGN DREDGE AREAS

	-5 MLW DREDGE (CY):	826 (17,925 SF)
	-7 MLW DREDGE (CY):	274 (10,511 SF)
	TOTAL (CY):	1,100 (28,436 SF)

PRIVATELY OWNED DREDGE AREAS

	-5 MLW DREDGE (CY):	436 CY (3,493 SF)
--	---------------------	-------------------

FILL AREAS (PRIVATELY OWNED)

	FILL TO 4.8' NAVD 88 (CY):	2,129 (7,461 SF)
--	----------------------------	------------------

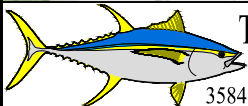

Turrell, Hall & Associates, Inc.
Marine & Environmental Consulting

3584 Exchange Ave. Naples, FL 34104-3732

Email: tuna@thanaples.com Phone: (239) 643-0166 Fax: (239) 643-6632

CRAYTON COVE MARINA PROPOSED DREDGE & FILL

THESE DRAWINGS ARE FOR PERMITTING PURPOSES ONLY AND ARE NOT INTENDED FOR CONSTRUCTION USE.

DESIGNED:	JR	REV#	REV BY	DATE	CHK BY	CHANGED
DRAWN BY:	RMJ	1.	-	-	-	-
CREATED:	07-08-20	2.	-	-	-	-
JOB NO.:	0566.1	3.	-	-	-	-
SHEET NO.:	10 OF 14	4.	-	-	-	-
		5.	-	-	-	-
SECTION-9		TOWNSHIP- 50S		RANGE- 25E		

P:\0566 - Crayton Cove Permitting\CAD\SHEET\PERMIT-STATE\0566.0 - FEDERAL.dwg \$R202/02/22/2020

CROSS SECTION

N.T.S.

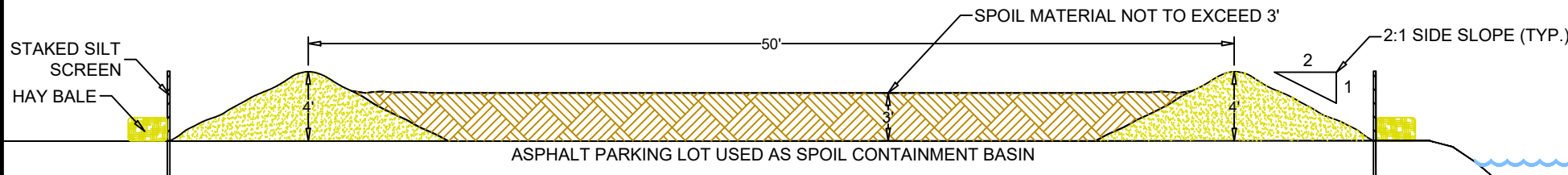

NOTES:

NO SPOIL RUNOFF INTO STATE WATERS

BOTH ENDS OF THE TURBIDITY CURTAIN SHOULD EXTEND FROM THE SHORELINE O COLUMN. PLACE THE APPROPRIATE # OF ANCHORS TO HOLD THE CURTAIN IN PLACE BASED ON THE VELOCITY OF THE WATERBODY AT THE TIME OF CONSTRUCTION AND ALLOW ENOUGH SLACK FOR BOTH FLOOD AND EBB CONDITIONS.

THE BARGE WILL BE WITHIN THE CONSTRUCTION AREA SURROUNDED BY THE TURBIDITY CURTAIN. TURBIDITY (NTU) WILL BE MONITORED TWICE DAILY, AT LEAST 4 HRS APART DURING ANY IN WATER WORK AT THE SITE. TURBIDITY STATIONS WILL BE LOCATED AT THE WATER'S SURFACE AND 1' ABOVE THE BOTTOM WITHIN THE CONSTRUCTION AREA, WITHIN ANY VISIBL E TURBIDITY PLUMES AND AT LEAST 150' DOWN CURRENT FROM THE WORK AREA. A BACKGROUND STATION WILL BE LOCATED AT LEAST 100 YARDS UP-CURRENT OR AGAINST THE TIDE FROM THE SAMPLES WITHIN THE CONSTRUCTION AREA AT THE WATER'S SURFACE AND 1' FROM THE BOTTOM.

ALL TURBIDITY DATA SHALL BE DOCUMENTED AND SUBMITTED TO DEP.

IF TURBIDITY LEVELS IN THE CONSTRUCTION AREA ARE 29 NTU'S GREATER THAN THOSE OF THE BACKGROUND STATION, ALL WORK MUST BE STOPPED AND DEP NOTIFIED.

DEP STAFF WILL NOTIFY WHEN WORK MAY CONTINUE.

CURTAIN WILL REMAIN IN PLACE UNTIL TURBIDITY LEVELS ARE NORMAL. SPOIL TO BE OFFLOADED FROM BARGE TO TEMPORARY HOLDING AREA VIA BARGE MOUNTED BACKHOE. SPOIL WILL BE MOVED TO PERMANENT SPOIL FIELD VIA UT TO THE WORK AREA FROM THE TOP TO THE BOTTOM OF THE WATERFRONT END LOADER.

TYPICAL TURBIDITY CURTAIN DETAIL

N.T.S.

TURBIDITY CURTAIN TO ENCLOSE ALL DREDGING ACTIVITIES.

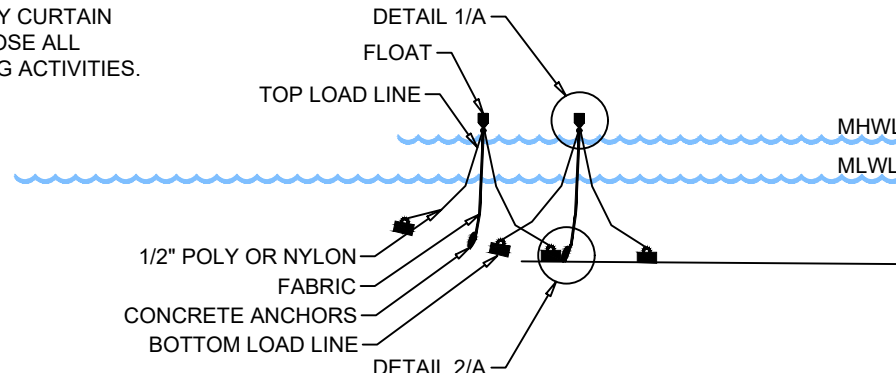

DETAIL 1/A

N.T.S.

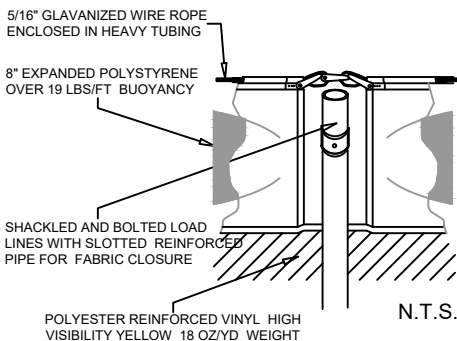

DETAIL 2/A

N.T.S.

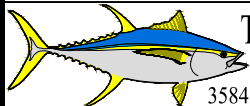
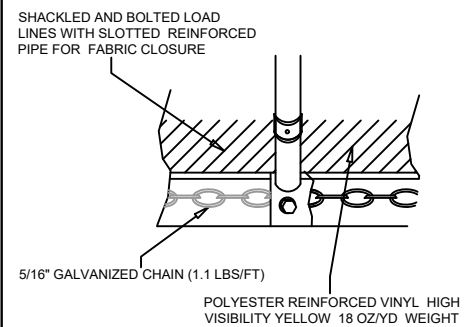

Turrell, Hall & Associates, Inc.
Marine & Environmental Consulting

3584 Exchange Ave. Naples, FL 34104-3732

Email: tuna@thanaples.com Phone: (239) 643-0166 Fax: (239) 643-6632

CRAYTON COVE MARINA

SPOIL CROSS SECTION MAP

THESE DRAWINGS ARE FOR PERMITTING PURPOSES ONLY AND ARE NOT INTENDED FOR CONSTRUCTION USE.

DESIGNED:	JR	REV#	REV BY	DATE	CHK BY	CHANGED
DRAWN BY:	RMJ	1.	-	-	-	-
CREATED:	07-08-20	2.	-	-	-	-
JOB NO.:	0566.1	3.	-	-	-	-
SHEET NO.:	11 OF 14	4.	-	-	-	-
		5.	-	-	-	-
SECTION-9		TOWNSHIP- 50S		RANGE- 25E		

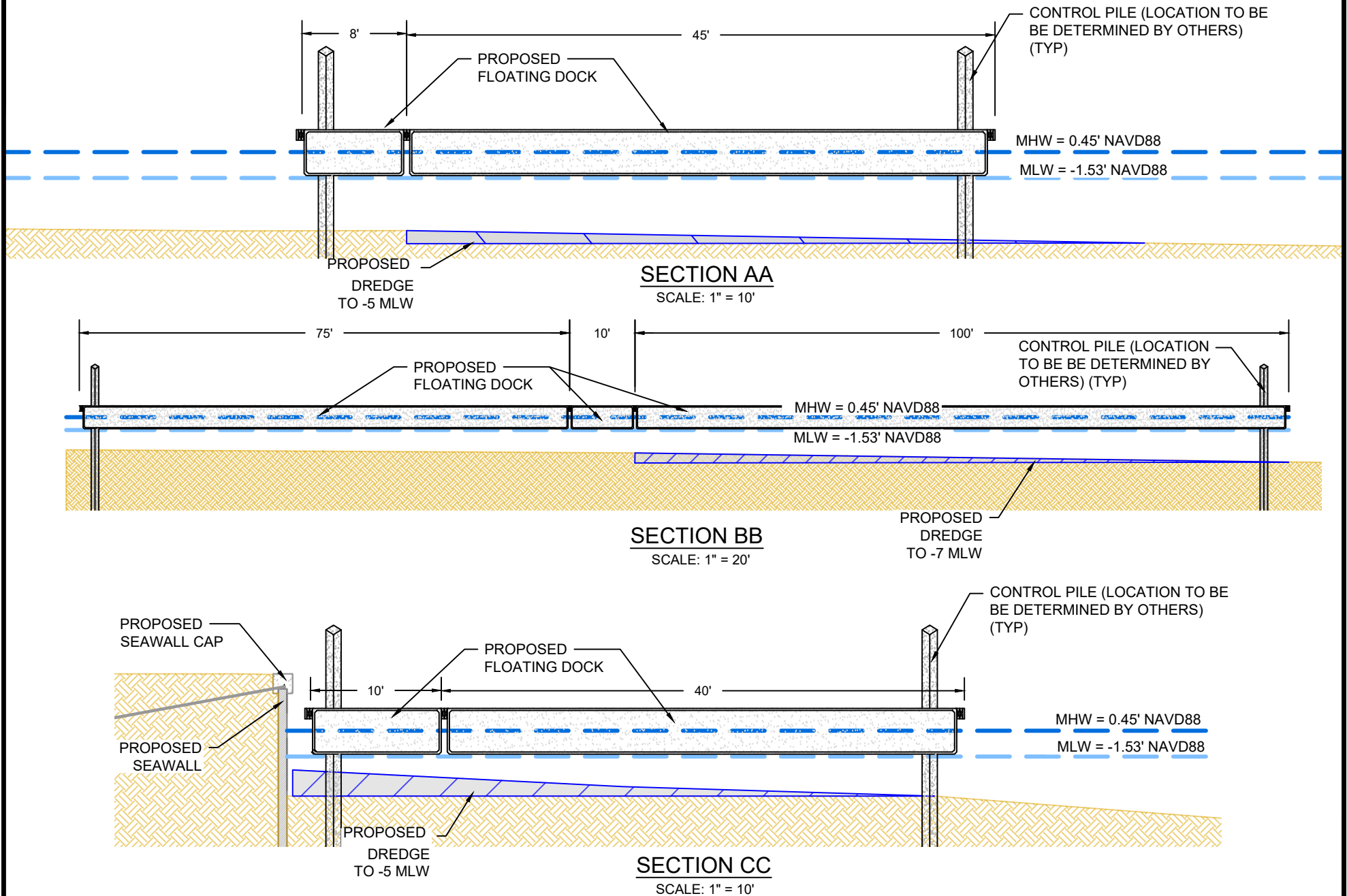

Turrell, Hall & Associates, Inc.
Marine & Environmental Consulting
3584 Exchange Ave. Naples, FL 34104-3732
Email: tuna@thanaples.com Phone: (239) 643-0166 Fax: (239) 643-6632

CRAYTON COVE MARINA **CROSS SECTIONS**

DESIGNED:	JR	REV#	REV BY	DATE	CHK BY	CHANGED
DRAWN BY:	RMJ	1.	-	-	-	-
CREATED:	07-08-20	2.	-	-	-	-
JOB NO.:	0566.1	3.	-	-	-	-
SHEET NO.:	12 OF 14	4.	-	-	-	-
		5.	-	-	-	-
SECTION-9		TOWNSHIP- 50		RANGE- 25		

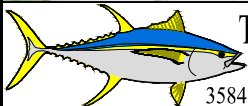
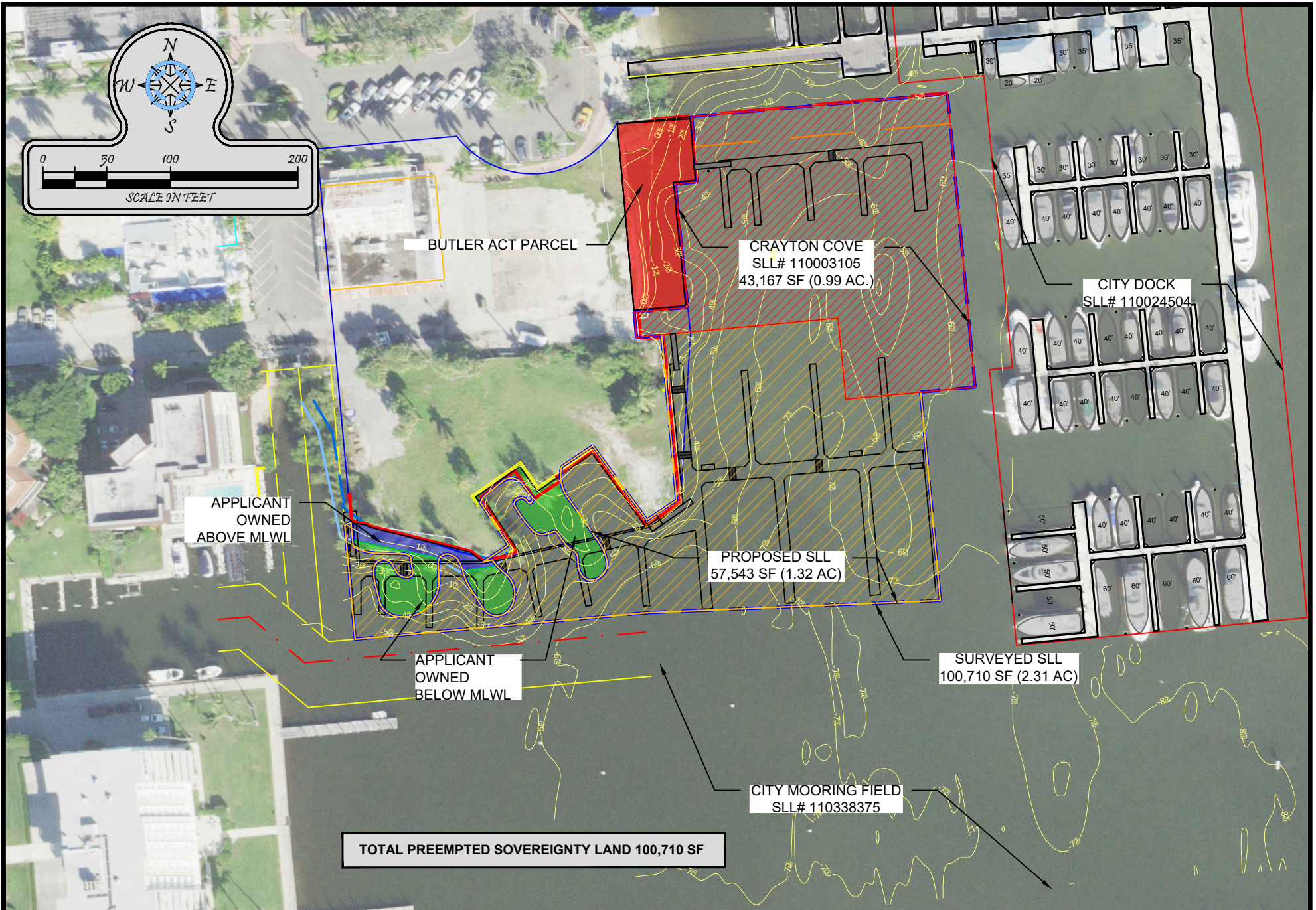

Turrell, Hall & Associates, Inc.
Marine & Environmental Consulting

3584 Exchange Ave. Naples, FL 34104-3732

Email: tuna@thanaples.com Phone: (239) 643-0166 Fax: (239) 643-6632

CRAYTON COVE MARINA

SUBMERGED LAND LEASE PLAN

THESE DRAWINGS ARE FOR PERMITTING PURPOSES ONLY AND ARE NOT INTENDED FOR CONSTRUCTION USE.

DESIGNED:	JR	REV#	REV BY	DATE	CHK BY	CHANGED
DRAWN BY:	RMJ	1.	-	-	-	-
CREATED:	07-08-20	2.	-	-	-	-
JOB NO.:	0566.1	3.	-	-	-	-
SHEET NO.:	13 OF 14	4.	-	-	-	-
		5.	-	-	-	-
SECTION-9		TOWNSHIP- 50S		RANGE- 25E		

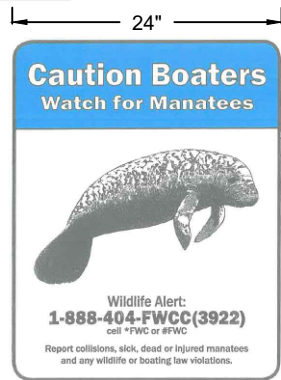
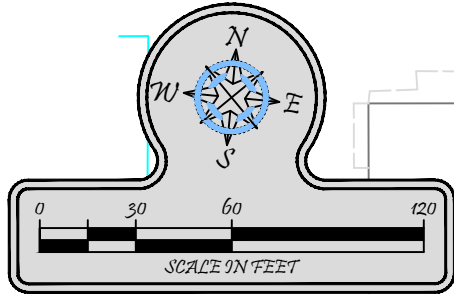

MANATEE SIGNAGE

FLOATING DOCK

MANATEE SIGNAGE

FLOATING DOCKS

MANATEE SIGNAGE

MANATEE SIGNAGE

FLOATING DOCKS

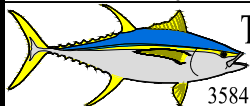

Turrell, Hall & Associates, Inc.
Marine & Environmental Consulting
3584 Exchange Ave. Naples, FL 34104-3732
Email: tuna@thanaples.com Phone: (239) 643-0166 Fax: (239) 643-6632

CRAYTON COVE MARINA **MANATEE PLAN**

DESIGNED:	JR	REV#	REV BY	DATE	CHK BY	CHANGED
DRAWN BY:	RMJ	1.	-	-	-	-
CREATED:	07-08-20	2.	-	-	-	-
JOB NO.:	0566.1	3.	-	-	-	-
SHEET NO.:	14 OF 14	4.	-	-	-	-
		5.	-	-	-	-
SECTION-9		TOWNSHIP- 50		RANGE- 25		